

# KENT

## 20" BUFFERS

KF-205U (600 RPM)

KF-205UA (600 RPM)

KF-205H (1000 RPM)

KF-205HA (1000 RPM)

### OPERATING & MAINTENANCE INSTRUCTIONS

### ILLUSTRATED PARTS LIST

October 1983



Write the model and serial number of your unit in the space provided. Refer to the rating plate on unit.

Model #

Serial #

Retain this owner's guide for future reference.

### THE KENT COMPANY

P.O. Box 1665

2310 Industrial Parkway

Elkhart, IN 46514 (219)293-8661

Western Branch: 9865 South Pioneer Blvd.  
Santa Fe Springs, CA 90670 (213)949-9351

## GENERAL INFORMATION

BEFORE YOU PLUG IN YOUR FLOOR MACHINE, check the voltage rating plate located on the back of the switch box cover below the handle grips to check if it agrees within 10% of the voltage available (See "Rating Plate") Connect only to a grounded (3-wire) electrical outlet (See "Grounding Instructions")

DO NOT OIL The motor in your floor machine is permanently lubricated and sealed Do not oil the motor at any time

## IMPORTANT SAFEGUARDS

Accidents due to misuse can only be prevented by those using the machine To guard against injury, basic safety precautions should be observed, including the following:

Read and follow all safety instructions

This machine is designed to be safe when used to perform the functions specified in the Owner's Guide Should damage occur to electrical or mechanical parts, the machine should be repaired by manufacturer or competent service station before using in order to avoid further damage to machine or physical injury to user

### Safety Recommendations: Be Safe — Avoid Hazards

- Your floor machine is equipped with a safety switch-lock and power switch triggers designed for *your* safety Do not attempt to bypass or defeat the safety switch-lock Never use any device to lock the power switch triggers in the ON position
- A damaged power cord could cause electrical shock and/or fire. To minimize this possibility observe the following precautions
  - Use care to keep electrical supply cord from contacting the rotating brush or drive block
  - Avoid closing doors on power cord, pulling it around sharp edges, or placing sharp-edged objects upon it
  - Wind cord no tighter than is necessary to retain it during storage Refer to Owner's Guide
  - When disconnecting power cord from electrical outlet, grasp the plug Pulling it out by the cord itself can damage cord insulation and internal connections to plug Also, avoid damage to insulation by keeping cord away from oil and heat.
- To avoid hazardous conditions, do not use your machine in areas where flammable and/or explosive vapors or dust are present
- Always disconnect the floor machine from electrical outlet before servicing machine, such as changing brushes, pads, etc
- Your floor machine is not a toy. Do not allow children or unauthorized personnel to play with unit Do not leave floor machine connected to an electrical outlet and left unattended
- Connect only to a grounded (3-wire) electrical outlet.
- Warning — To avoid electrical shock, use indoors only.
- Warning — This machine is designed for high speed buffing only. It cannot be used for scrubbing, or shampooing.

**SAVE THESE INSTRUCTIONS**

## GROUNDING INSTRUCTIONS

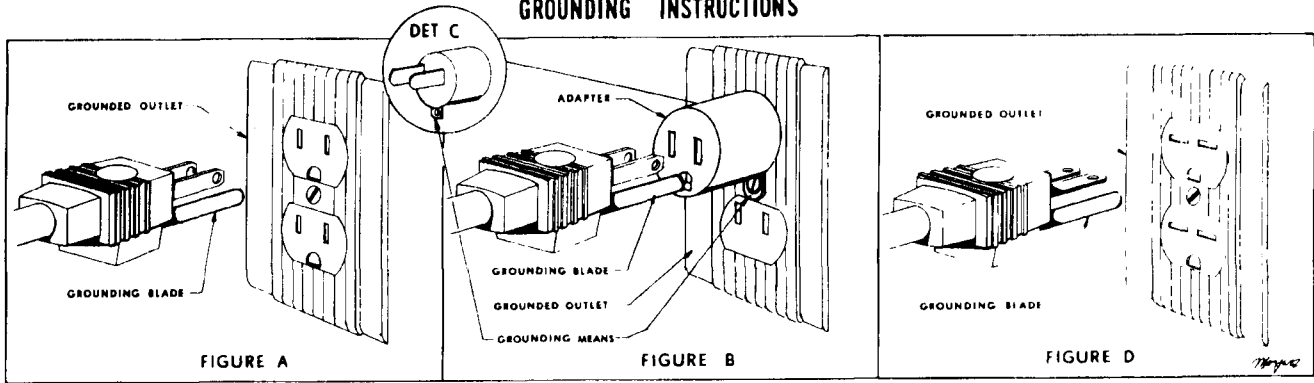

This floor finishing machine should be grounded while in use to protect the operator from electric shock. The machine is equipped with a 3 conductor cord and a 2 prong grounding type attachment plug cap to fit the proper grounding type receptacle. The green (or green & yellow) conductor in the cord is the grounding wire. Never connect this wire to other than the grounding blade.

**FLOOR FINISHING MACHINES RATED LESS THAN 150 VOLTS**— If the floor finishing machine is provided with an attachment plug cap as shown in Figure A, it is intended for use on a 120 Volt (nominal) circuit. If a properly grounded receptacle as shown in Figure A is not available, an adapter as shown in Det.C is available and should be installed as shown in Figure B if the outlet box that houses the receptacle is grounded. Be sure to fasten the grounding tab with the faceplate screw.

**FLOOR FINISHING MACHINES RATED 150 - 250 VOLTS** — If the machine is provided with an attachment plug cap as shown in Figure D, it is intended for use on a 240 Volt (nominal) circuit. No adapter is available for this cap.

### SERVICE INFORMATION

To obtain consistent performance over the life of your floor machine, read through these instructions and keep them handy for future reference. If you require service, contact the dealer from whom the floor machine was purchased, or the authorized Kent Service Agency. Always refer to your Kent Limited Warranty for complete service information.

MODEL	<input type="text"/>	SERIAL	<input type="text"/>
CYCLE	<input type="text"/>	PHASE	<input type="text"/>
VOLTS		<input type="text" value="115"/>	
BR. MOTOR		OTHER MOTOR	
AMP	<input type="text"/>	AMP	<input type="text"/>
H.P.	<input type="text"/>	H.P.	<input type="text"/>
<b>THE KENT COMPANY</b>			
<b>ELKHART, INDIANA</b>			
MADE IN U.S.A.			

The model, type, and serial number are indicated on the rating plate. For prompt and complete service information, always refer to these numbers when inquiring about service.

### HOW TO USE YOUR FLOOR MACHINE

Your floor machine is packed completely assembled and ready for use after you install the drive block. (Pads are not provided with the unit but are available at additional cost.)

When ordering pads or drive blocks, remember that the block diameter is always two inches smaller than the pad diameter. Refer to the following chart and specify either brush or block diameter when ordering.

MACHINE SIZE	PAD DIAMETER	BLOCK DIAMETER
20"	20"	18"

## How To Use Your Floor Machine . . . continued

### Handle Adjustment

The handle of your floor machine can be adjusted to any comfortable work position. Simply pull upward on the handle locking device located on the lower handle shaft to release the lock. Then adjust the handle to the desired position and push down firmly on the handle locking device to lock handle in position.

The proper handle position adjustment will greatly improve the handling ability of the machine. Adjust the handle to a position where you can control the machine easily and comfortably. You will want to experiment with the handle position to find the handle height at which the unit operates best for you.

**NOTE** – Always lower handle to operating position before turning the machine on.

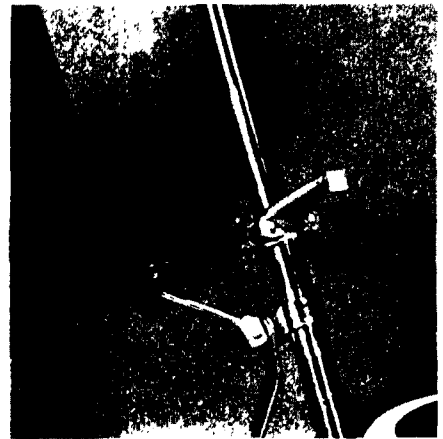

### On/Off Power Switch Triggers

The ON/OFF switch is conveniently located in the form of dual triggers underneath the handle grips.

### To Turn Machine On

Handle should be lowered to operating position before turning machine on. Place both hands firmly on handle grips with fingers around power triggers. Do not apply pressure on triggers before safety switch-lock is disengaged.

Disengage safety switch-lock by pushing it away from you with one thumb. Then, while holding safety switch-lock in disengaged position, squeeze the power triggers toward the handle grips and return thumb to handle grip.

To stop machine, simply release triggers. Safety switch-lock will automatically return to engaged position.

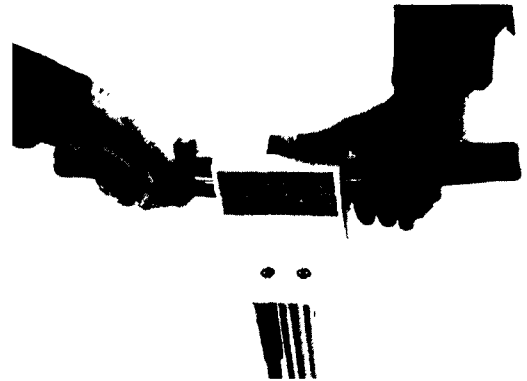

### Circuit Breaker

If the machine becomes overloaded, it will turn off automatically. It is recommended that the cause of overloading the machine be determined before restarting. To restart, wait one minute after machine shuts off then press reset button located on the side of the switch box.

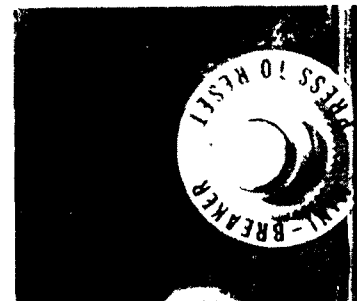

## How To Use Your Floor Machine . . . continued

### DRIVE BELT ADJUSTMENT

When drive belt adjustment is necessary:

1. Loosen the 4 nuts securing the drive motor to the frame.
2. Adjust belt tension screw by evenly turning clockwise the two screws at the rear of the frame one turn.
3. Test machine with pad and pad holder. If belt slips, adjust further. If belt does not slip, tighten motor screws.

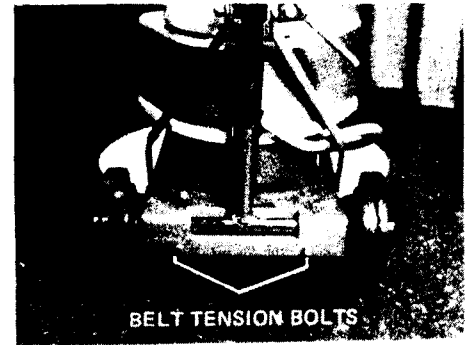

### Storage

Store machine by tilting back so that all four wheels rest on floor. This elevates the drive block so that it need not be removed between uses. Detachable supply cord may be coiled and stored separately or with machine.



### GUIDELINE FOR OPERATION (600 RPM & 1000 RPM MACHINES)

Your floor machine is a very sensitive, powerful unit. When in operation, it should be guided gradually and smoothly without sudden or rough motions. You will want to practice with your machine on a smooth surface first until you have experience in operating it.

Always adjust the handle to a height that is comfortable for your operation. (See "Handle Adjustment").

Do not use this floor machine for purposes other than buffing. The pad assembly revolves too quickly for scrubbing or shampooing. After being used, your floor machine can be wiped clean with a soft, damp cloth and should be stored in a clean, dry place. Do not allow machine to rest on pad for an extended period of time. The pad could take a set and cause the machine to vibrate excessively.

### MODEL KF-205U (600 RPM MACHINE), ALSO KF-205UA (600 RPM MACHINE)

BEGIN OPERATING THE FLOOR MACHINE WITH THE BRUSH OR PAD SURFACE LEVEL, BALANCED, AND FLAT ON THE FLOOR.

Before operating the floor machine, adjust handle to lowest comfortable operating position and lock handle cam. Tilt handle down slightly and start motor. If floor machine tends to go to the left at once, stop motor and adjust caster assemblies downward, turning socket head cap screws clockwise. Restart motor and check setting again - correct caster adjustment and lowest motor operating load (amperes input) is when the operator can support handle slightly and machine will move to either side, a slight "down" movement of handle makes machine move left or a slight "up" movement of handle makes machine move to the right. Some adjustments may periodically be necessary when changing pads due to slight thickness variations. **CAUTION** - Do not allow machine to rest on pad for extensive periods because this causes a set in pad resulting in wobble during operations. Place machine in storage position resting on all four wheels.

### MODEL KF-205H (1000 RPM MACHINE), ALSO KF-205HA (1000 RPM MACHINE)

BEGIN OPERATING THE FLOOR MACHINE WITH PAD SURFACE LEVEL AND FLAT ON THE FLOOR.

The weight of the machine remains on the rear wheels during operation. Do not attempt to guide the machine from left to right as is done with other floor machines. Move the machine forward at an even, continuous rate. If the machine is held in one spot too long, the high speed of the pad may damage the floor's shine.

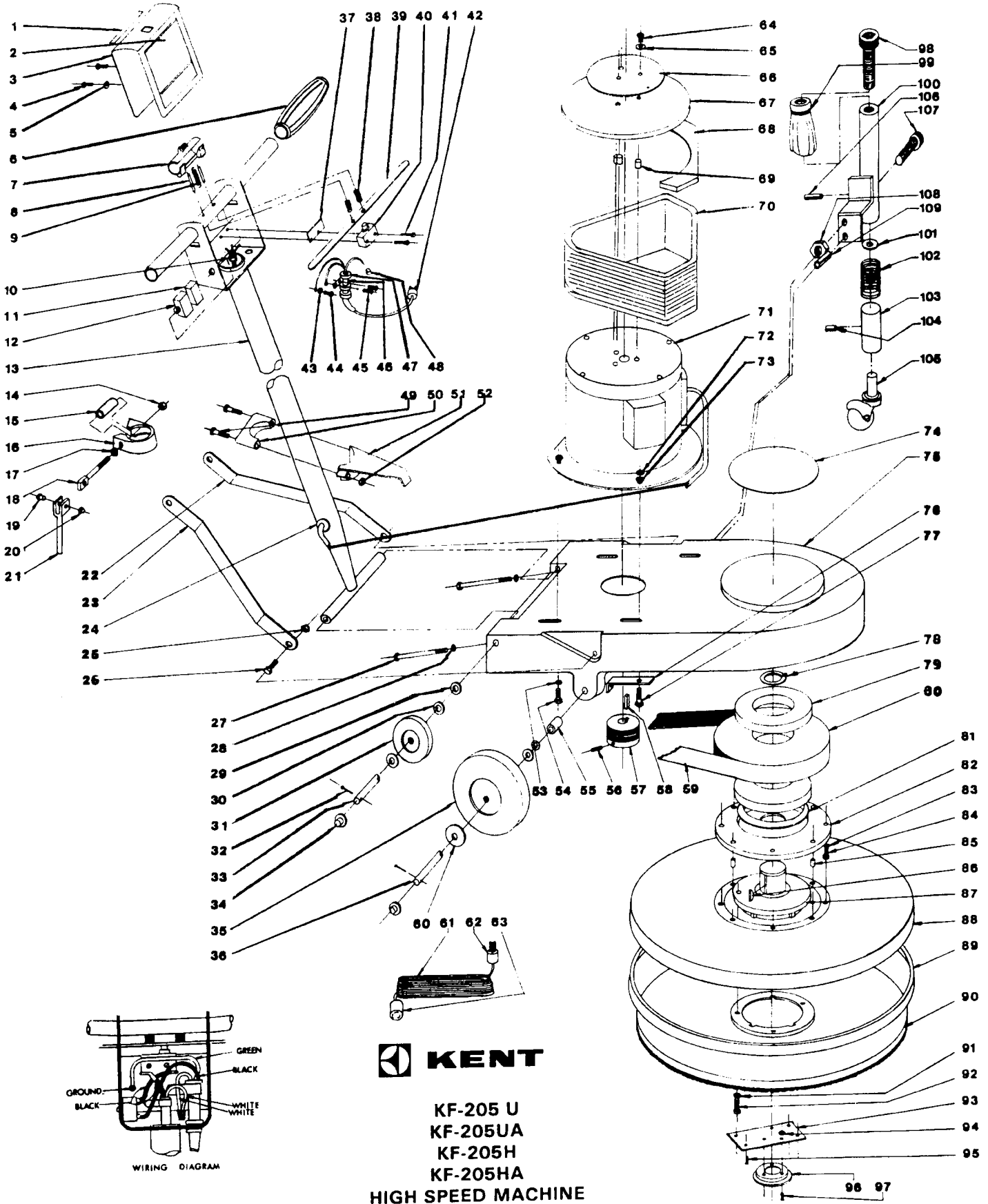

REF. NO.	KF205U	KF205M	KF205H	KF205HA	DESCRIPTION	NO. REQ.
1	50785	50785	50785	50785	Label, "Tilt to Start"	1
2	51901	51901	50784	50784	Nameplate - Switch Box	1
3	33290	33665	33290	33665	Cover Assembly - Switch Box	1
4	01331	01331	01331	01331	Screw, 10-24 x 3/4	2
5	04253	04253	04253	04253	Lockwasher, #10 Ext	2
6	46652	46652	46652	46652	Handle Grip - Blue	2
7	50588	50588	50588	50588	Safety Switch	1
8	05467	05467	05467	05467	Roll Pin, 1/8 x 1-3/4	2
9	48785	48785	48785	48785	Spring	1
10	46647	46647	46647	46647	Clamp - In Handle Cord	1
11	50252	50252	50252	50252	Sleeve	1
12	26699	26699	26699	26699	Circuit Breaker - 20 Amp	1
13	33047	33047	33047	33047	Handle Weldment	1
14	05279	05279	05279	05279	Nut - 3/8-16 Hex	1
15	46606	46606	46606	46606	Spacer Guide - Clamp Stud	1
16	46595	46595	46595	46595	Clamp - Handle Lock	1
17	46607	46607	46607	46607	Washer, Hardened	1
18	46597	46597	46597	46597	Clamp - Stud	1
19	04314	04314	04314	04314	Rivet - 5/16 x 3/4 Rd Hd	1
20	46632	46632	46632	46632	Push Nut - 5/16	1
21	46596	46596	46596	46596	Cam - Handle Lock	1
22	50767	50767	50767	50767	Connecting Leg - Left	1
23	50766	50766	50766	50766	Connecting Leg - Right	1
24	46651	46651	46651	46651	Grommet	1
25	03368	03368	03368	03368	Nut - 3/8-16 Flex Lock	2
26	03265	03265	03265	03265	Bolt - 3/8-16 x 1-1/2	2
27	05558	05558	05558	05558	Screw - 1/4-20 x 5-1/2 Hex Hd	2
28	04254	04254	04254	04254	Lockwasher - 1/4 Tooth	2
29	05449	05449	05449	05449	Washer - Spring	2
30	04230	04230	04230	04230	Washer - 1/2 x 3/4 x 1/32	8
31	11-1639	52713	11-1639	52713	Wheel	2
32	05383	05383	05383	05383	Cotter Pin	4
33	50765	50765	50765	50765	Axle Shaft - Rear	1
34	E48939	52204	E48939	52204	Push Nut - Or Hub Cap	4
35	----	----	50776	52218	Wheel - 6 In Diameter	2
36	----	----	50764	50764	Axle - Shaft - Front	1
37	46653	46653	46653	46653	Insulation - Switch	1
38	46648	46648	46648	46648	Spring - Trigger	2
39	46643	46643	46643	46643	Trigger	1
40	26412	26412	26412	26412	Switch	1
41	01312	01312	01312	01312	Screw, 6-32 x 1 Rd Hd	2
42	26672	26672	26672	26672	Plug - Hubbell - Twist Lock	1
43	05347	05347	05347	05347	Washer - #8 Brass	1
44	01255	01255	01255	01255	Screw, 8-32 x 3/8 Rd Hd	1
45	01332	01332	01332	01332	Screw, 10-24 x 3/8	3
46	46642	46642	46642	46642	Strain Relief - Clamp	1
47	25528	25528	25528	25528	Power Cord - Short	1
48	26400	26400	26400	26400	Wire Nut	1
49	05515	05515	05515	05515	Screw, 5/16-18 x 1-3/4 Rd Hd	2
50	48572	48572	48572	48572	Cap - Cord Hook	1
51	48571	48571	48571	48571	Body - Cord Hook	1
52	03349	03349	03349	03349	Nut, 5/16-18 Hex	2
53	04217	04217	04217	04217	Washer, 5/16 x 5/8	2
54	03246	03246	03246	03246	Bolt, 5/16-18 x 1	2
55	----	47075	47075	47075	Spacer - 6 In Wheel	2
56	05387	05387	05387	05387	Set Screw, 5/16-18 x 1/2	1
57	51898	50779	50779	50779	Pulley - Driver	1
58	40673	40673	40673	40673	Key	1
59	51894	50778	50778	50778	Belt	1
60	----	04475	04475	04475	Washer, 1/2 x 1-7/8 x 12 Ga	2
61A	25526	25526	25526	25526	Power Cord Asm - Incl 61-63	1
61	25527	25527	25527	25527	Power Cord, 75 Ft	1
62	26675	26675	26675	26675	Plug-Hosp. Grade (Service Only)	1
63	26676	26676	26676	26676	Connector Body (Female)	1
64	01369	01369	01369	01369	Screw, #10-32 x 3/4 Pan Hd	3
65	04253	04253	04253	04253	Lockwasher #10	3
66	50060	50060	50060	50060	Nameplate - Drip Cover	1
67	49589	50013	49589	50013	Drip Cover	1
68	50781	50781	50781	50781	Cover - Motor Capacitor	1
69	50872	50872	50872	50872	Fibre Spacer	3

REF. NO.	KF205U	KF205M	KF205H	KF205HA	DESCRIPTION	NO. REQ.
70	50903	50903	50903	50903	Cover - Motor	1
71	24196	24196	24196	24196	Motor - 115 Volt, 60 HB, 1-1/2 HP	1
71	24243	24243	24243	24243	Motor - 110 Volt, 50 HB, 1-1/2 HP	1
71	24197	24197	24197	24197	Motor - 230 Volt, 50 HB, 1-1/2 HP	1
72	03349	03349	03349	03349	Nut - 5/16-18	4
73	04212	04212	04212	04212	Lockwasher - 5/16 Split	4
74	51900	51900	50783	50783	Nameplate	1
75	50761	50761	50761	50761	Frame - High Speed	1
76	50941	50941	50941	50941	Bracket - Bolt Adjustment	4
77	03249	03249	03249	03249	Bolt, 5/16-18 x 1-1/4	2
78	04473	04473	04473	04473	Key Pin, 1-3/8	1
79	27219	27219	27219	27219	Bushing, 1-3/8 x 3-9/64	2
80	50774	50774	50774	50774	Pulley - Driven	1
81	04474	04474	04474	04474	Spring Washer	1
82	50762	50762	50762	50762	Housing - High Speed	1
83	02278	02278	02278	02278	Lockwasher - 1/4" Sp. Ld	4
84	02260	02260	02260	02260	Screw, Allen - 1/4-20 x 1	4
85	04477	04477	04477	04477	Dowel Pin - 1/4 x 1-1/2	2
86	50775	50775	50775	50775	Key - Woodruff	1
87	33241	33241	33241	33241	Clutch and Shaft Weldment	1
88	49584	46323	49584	52318	Cover - Brush 20'	1
89	49587	49587	49587	49587	Bumper - 20	1
90	20329	20329	20329	20329	Pad Holder Ass'y	1
91	02278	02278	02278	02278	Lockwasher - 1/4 Split	3
92	02253	02253	02253	02253	Screw 1/4-20 x 3/4	3
93	50948	50948	50948	50948	Support Plate	1
94	22-2224	22-2224	22-2224	22-2224	Nut #10-24 Hexlock	3
95	05560	05560	05560	05560	Wood Screw, #10 x 3/4 Rd Hd	4
96	50945	50945	50945	50945	Clamping Plate	1
97	01283	01283	01283	01283	Screw, #10-24 x 3/8 Rd Hd	3
98	09049	09049	09049	09049	Allen Wrench 5/32	1
99	01477	01477	----	----	Screw, Soc Hd Cap - 5-13 x 2 1/2	2
99	51897	51897	----	----	Guard, Furniture	2
100	33585	33585	----	----	Weldment, Bracket - Caster, Right	1
100	33586	33586	----	----	Weldment, Bracket - Caster, Left	1
101	05433	05433	----	----	Washer, Flat	2
102	51889	51889	----	----	Spring	2
103	51890	51890	----	----	Spacer Steel Caster	2
104	02408	02408	----	----	Pin, Spring	2
105	51895	51895	----	----	Caster, Swivel - 2 Ball	2
106	05484	05484	----	----	Pin, Spring	2
107	01475	01475	----	----	Screw, Cap Soc 1/2-13 x 1-3/4	2
108	03296	03296	----	----	Nut, 1/2-13	2
109	01476	01476	----	----	Pin, Roll - 1/2 x 1	2

ITEMS NOT IN WB						
27177	27177	27177	27177	27177	Bearing - Top, Motor	1
27212	27212	27212	27212	27212	Bearing - Bottom, Motor	1
24207	24207	24207	24207	24207	Capacitor Start - 704 µfd	1
24206	24206	24206	24206	24206	Capacitor Run - 20 µfd	1
26677	26677	26677	26677	26677	Stationary Switch	1
26678	26678	26678	26678	26678	Centrifugal Switch - 60 HB	1
26770	26770	26770	26770	26770	Centrifugal Switch - 50 HB	1
38653	38653	38653	38653	38653	Armature A.m. - No Bearing or Switch (for 24196 Motor ONLY)	1

# THE KENT LIMITED WARRANTY

Your Kent Equipment, which has been manufactured, tested and inspected in accordance with carefully specified engineering requirements, is warranted to be free from defects in material and workmanship.

This warranty is, however, subject to the following qualifications, conditions, and limitations which are set forth to provide you and all users of the Kent Equipment with information concerning the duration, extent, availability, and applicability of this Kent Limited Warranty, the procedure to be taken to obtain its performance, and other information concerning the Kent Warranty policy.

## DURATION OF WARRANTY AND TO WHOM EXTENDED

This warranty extends for a period of one year from the date of the original purchase of the Kent Equipment by the original purchaser.

## PARTS OF KENT EQUIPMENT NOT COVERED BY WARRANTY

Certain parts of Kent Equipment require replacement in the ordinary course of use due to normal wear by reason of their characteristics. These are normal wear items such as cords, gaskets, switches, bumpers, carbon brushes, handle grips, bags, hoses, bearings, etc.

## EXCEPTIONS AND EXCLUSIONS FROM WARRANTY

This equipment is required to be used on electric current as indicated on the name plate. Otherwise damage, defects, malfunctions or other failures of the equipment arising from use on electric current not as indicated are excepted and excluded from this warranty.

Defects, malfunctions, failure or damage of the equipment caused by improper, unreasonable or negligent use or abuse while in the possession of the purchaser are likewise excluded from this warranty.

If repair is done on your equipment by anyone other than those below designated as authorized to perform such work without first having obtained factory instructions, The Kent Company, at its sole option, may determine that this warranty will not apply and that reimbursement for such repair will not be made because of the failure to comply with such factory specified instructions.

## FIVE YEAR POLY COMPONENT WARRANTY

Your Kent rotational molded polyethylene parts have been manufactured, tested and inspected in accordance with carefully specified engineering requirements and are warranted to be free from defects in material and workmanship.

This warranty extends for a period of five (5) years from the date of the original purchase of the Kent equipment by the original purchaser.

This warranty will not cover damage attributable to the following:

- (1) Improper, unreasonable or negligent use or abuse of the equipment.
- (2) Use of the equipment with hot water or high temperatures above 130° Fahrenheit (54°Centigrade).
- (3) "Warpage", "creepage" or "distortion" of part so long as the same does not interfere with normal operation.
- (4) Abrasions or punctures of the equipment.

## PROCEDURE TO BE TAKEN TO OBTAIN PERFORMANCE OF WARRANTY

### REPAIR

To secure repair of the equipment or any warranted parts under this warranty, the following procedure should be taken.

The inoperative equipment or warranted parts, together with satisfactory evidence of the purchase date, must be delivered, with shipping and delivery charges prepaid, to one of the following:

- 1) The Dealer from whom purchased;
- 2) Any Kent distributor's Service Department in the United States;
- 3) Any Kent Authorized Service Station in the United States.

If you are unable to locate any of the foregoing, you may write or otherwise communicate with The Kent Company, Division of Dometic Incorporated, for instructions before repair service is performed by anyone else. In such event, The Kent Company will provide either the location of a closely available Kent distributor Service Department or Kent Authorized Service Station or other factory instructions.

Upon compliance with the above procedure, all warranted defects will be repaired, at no additional charge or costs to the customer, and the repaired product returned to the customer, with all shipping and delivery charges prepaid.

In following the procedures above set forth, PLEASE MAKE CERTAIN to state the Kent model, type and serial number as shown on the name plate of the equipment.

### REPLACEMENT

In the event of a defect, malfunction or failure of your Kent Equipment or any warranted part to conform with this warranty, The Kent Company may, at its sole option and own expense, replace the equipment or any warranted part with another new identical or reasonably equivalent model or part in lieu of repairing the defect.

## NO REFUND OF PURCHASE PRICE

The Kent Company will not, as a matter of its warranty policy, refund the customer's purchase price.

## WARRANTY REGISTRATION CARD FOR YOUR KENT EQUIPMENT AND REQUESTS FOR INFORMATION

Your Kent Company Distributor from whom you purchased your equipment is responsible for the registration of your warranty with the factory. We ask that you cooperate with your Distributor in supplying the necessary information on the warranty card so that we may better serve you.

Any information or questions you may have concerning your Kent Equipment or this warranty may likewise be secured from the factory.

This warranty gives you specific legal rights, and you may also have other rights which vary from state to state.

THE KENT COMPANY - P.O. BOX 1665 - ELKHART, INDIANA 46515