

MAXIMATIC



INSTRUCTION MANUAL



- OPERATION

- CARE

- SERVICE

Models MX22 & MX28



WINDSOR INDUSTRIES, INC., 1351 W. Stanford Ave., Englewood, CO 80110 USA • 3031762-1800 • FAX 3031762-0817

IMPORTANT SAFETY INSTRUCTIONS

When using an electrical appliance, basic precautions should always be followed, including the following:

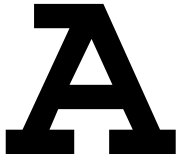

Read all instructions before using this machine. This machine is for commercial use.

WARNING: TO REDUCE THE RISK OF FIRE, ELECTRICAL SHOCK, OR INJURY:

1. Do not use outdoors or expose to rain.
2. Machines can cause a fire when operated near flammable vapors or materials. Do not operate this machine near flammable fluids, dust, vapors or gas. Do not pick up burning materials such as cigarettes or matches.
3. Do not leave the machine unattended. Unplug machine from power outlet when not in use.
4. Switch off switches before disconnecting power cord from electrical outlet.
5. Maintenance and repairs must be done by qualified personnel.
6. Do not disconnect cord from outlet by pulling on cord. Grasp plug to remove from outlet.
7. Do not use power cord as a handle, close door on cord, or pull cord around sharp edges or corners.
8. Do not operate machine with any openings blocked. Keep openings free of debris that may reduce air flow.
9. Do not use machine as a step or operate machine unless it is completely assembled.
10. Do not use without dust bag in place.

SAVE THESE INSTRUCTIONS

INSPECTION

Carefully unpack and inspect your vacuum for shipping damage. Each unit is operated and thoroughly inspected before shipping, and any damage is the responsibility of the carrier who should be notified immediately.

ELECTRICAL

This vacuum operates on a standard 15 amp, 115 volt AC circuit. Voltages below 105 volts or above 125 volts could cause serious damage to motors.

*230 volt 50 hz model available.

WARNING: Make sure you are using the correct voltage as specified on nameplate before connecting machine power cord to outlet.

WARNING: To avoid electric shock, use indoors only.

GROUNDING INSTRUCTIONS

To protect the operator from electric shock, this machine must be grounded while in use. The vacuum is equipped with an approved three-conductor power cord and three-prong grounding type plug to fit the proper grounding type receptacle. The vacuum power cord has a plug as shown in Fig. A. If a receptacle connected to the electrical ground as shown in Fig. A is not available use an adapter as shown in Fig. C. The adapter must be connected to an electrical ground in the electrical outlet, using metal screw shown in Fig. B.

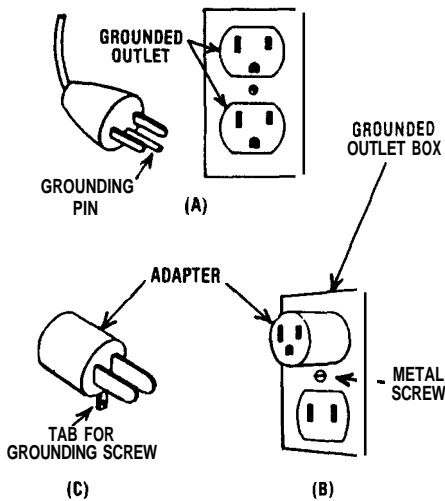

WARNING: If an extension cord is used it must be an approved 3-wire cord with a minimum wire size of 12/3 AWG and a maximum length of 50 ft.

EQUIPMENT SETUP

NOTE: Attach strain relief/cord retainer to power cord.

1. Make loop in power cord approximately 18" from main housing.
2. Slide cord loop through slot in retainer and over retainer arm. Pull slack cord back through slot to secure.

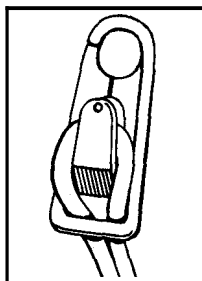

FILTER BAG

Install filter bag opening around the lip of opening on hopper cover. Secure bag by pulling bag strap tight.

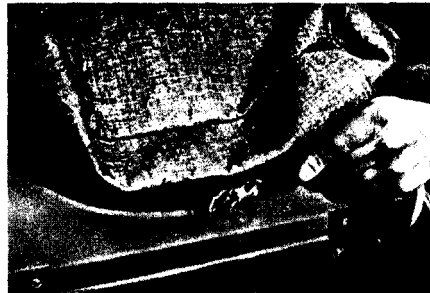

NOTE: Optional plastic disposable bags are available and can be installed in the debris collector bin as shown in Photo 3.

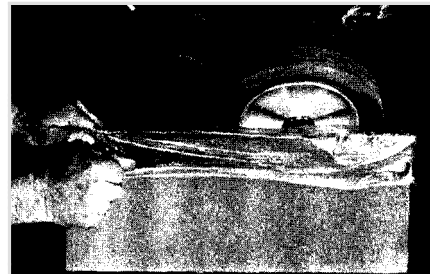

HANDLE

The folding handle has two locked positions; operating and folded for storage. To move handle from either locked position pull out on both locking knobs and rotate 1/4 turn. Move handle to position needed and return knobs to the locked position.

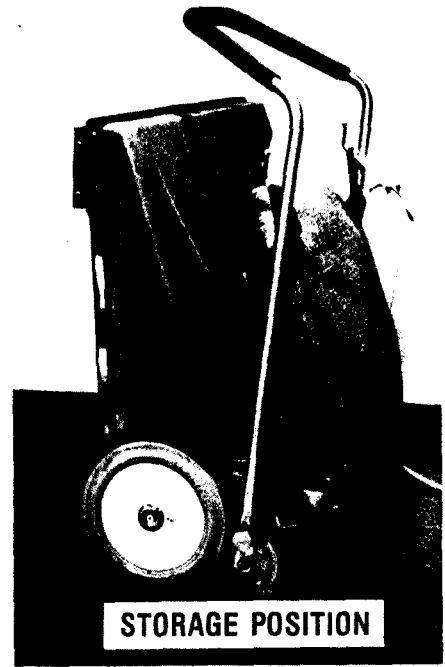
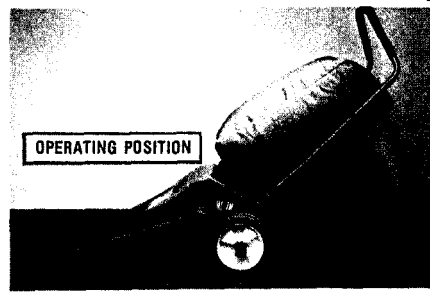

BRUSH HEIGHT ADJUSTMENT

WARNING: Do not leave brush running unattended when machine is in cleaning mode. Damage to carpet could occur.

To adjust the brush height, press down on knob and move lever to the correct setting for the carpet being vacuumed. The brush setting is correct when the bristles sweep the surface of the carpet.

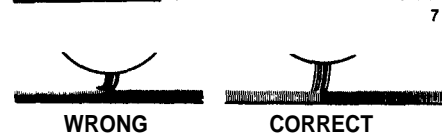

HOPPER SWITCH

The vacuum is equipped with a safety switch to prevent the machine from being switched on when the hopper cover is open.

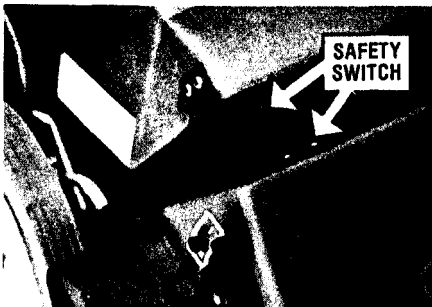

OPERATING MAXIMATIC VACUUM

The vacuum is designed for use on large carpeted areas such as airport concourses, hotel ballrooms/meeting rooms, etc.

1. Large debris such as paper cups, plates, etc., should be picked up before starting the cleaning process.
2. Plan your cleaning route to work away from the electrical source. Move machine forward at a steady pace.

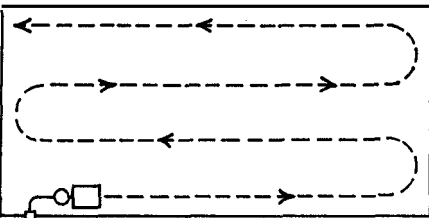

WARNING: Do not push vacuum over power cord while machine is running. Always lift cord over vacuum.

WARNING: Before opening hopper cover switch off machine and wait until fan rotation stops to prevent dust and debris from being ejected.

3. To keep the vacuum operating at maximum efficiency: Periodically switch off the machine, shake vacuum bag to allow the finer dirt and dust to settle into the hopper. Open hopper cover, lift out dust bin and empty.

CIRCUIT BREAKER

The vacuum is equipped with a circuit breaker to protect the motor in the event an excessive overload condition occurs. If the breaker trips, wait 2 minutes before resetting. If the breaker trips immediately after resetting, check for probable cause such as:

- A. Brush adjustment set too low.
- B. Obstructions in brush roller or impeller.

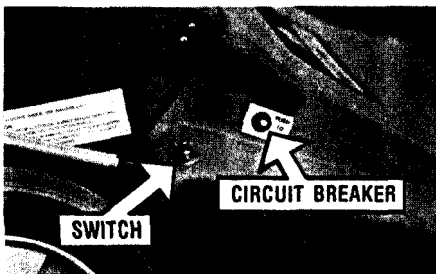

REGULAR MAINTENANCE

1. Shake down bag and empty debris bin, daily.
2. Check power cord for damaged or frayed insulation.
3. Return brush adjustment lever to "store" position when machine is not in use.
4. Every 4 to 6 months remove wheels, clean axles, and apply a thin coating of silicone lubricant to axles.
5. The filter bag can be washed twice before losing the filtering ability. This should be done using a mild detergent in cool water and hung up to drip-dry.

SERVICING THE MAXIMATIC

WARNING: Remove machine power cord from electrical source before making any repairs or adjustments to the machine.

To access impeller assembly/belt and motor.

1. Release hopper cover latches and tilt cover back.
2. Remove (4) screws holding main cover to chassis. (2) located at front corners and (2) at front inside of rear wheels. Lift up RIGHT side of cover and slide to left to remove.

BELT/BRUSH

1. Loosen idler pulley and roll belt off motor pulley.
2. Remove belt/brush pulley guard.
3. Remove screw from each end of brush shaft and remove brush assembly.

NOTE: When installing a new belt or motor, centerline distance between motor shaft and brush shaft should be set at 12 3/8 Inches.

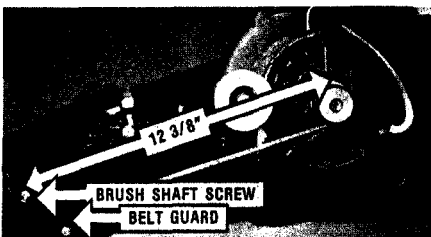

IMPELLER ASSEMBLY/BRUSH DRIVE MOTOR IMPELLER

1. Remove intake duct.
2. Remove impeller housing cover.
3. Loosen (2) screws in impeller and remove from motor shaft.

MOTOR

1. Loosen idler and roll belt off motor pulley.
2. Remove intake duct, impeller and housing.
3. Disconnect motor leads from terminal block.
4. Remove (4) bolts holding motor to chassis.

NOTE: When re-installing motor use a straight edge to check pulley alignment between brush and motor pulleys.

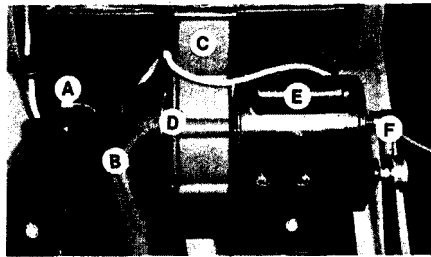

- | | |
|---------------------|-------------------------|
| A. Terminal Block | D. Cover |
| B. Intake Duct | E. Impeller/Brush Motor |
| C. Impeller Housing | F. Belt |

CASTERS/BRUSH HOUSING SHOES

NOTE: When replacing casters or shoes the dimensions shown in Drawing 12 must be made to maintain efficiency of the vacuum.

NOTE: Make adjustments with the machine in store position setting on a LEVEL surface and with the casters pointing rearward.

1. The distance between surface and bottom of rear brush housing should be 9/16 in. Check both right and left side of housing.
2. When replacing shoes install a screw at each end of shoe first. Using a straight edge install balance of screws keeping shoe straight.

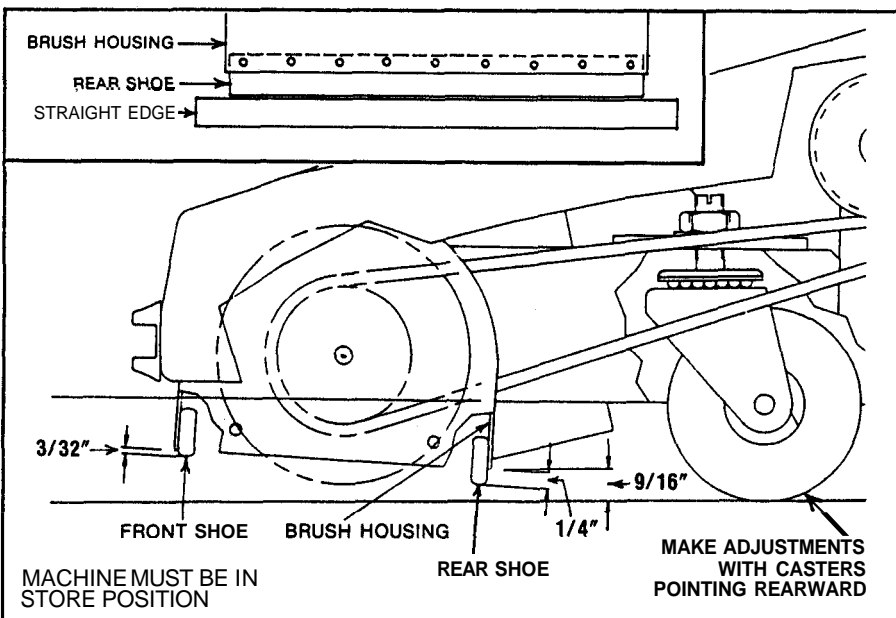

MX22 & G1 8 CHASSIS ASSMBLY

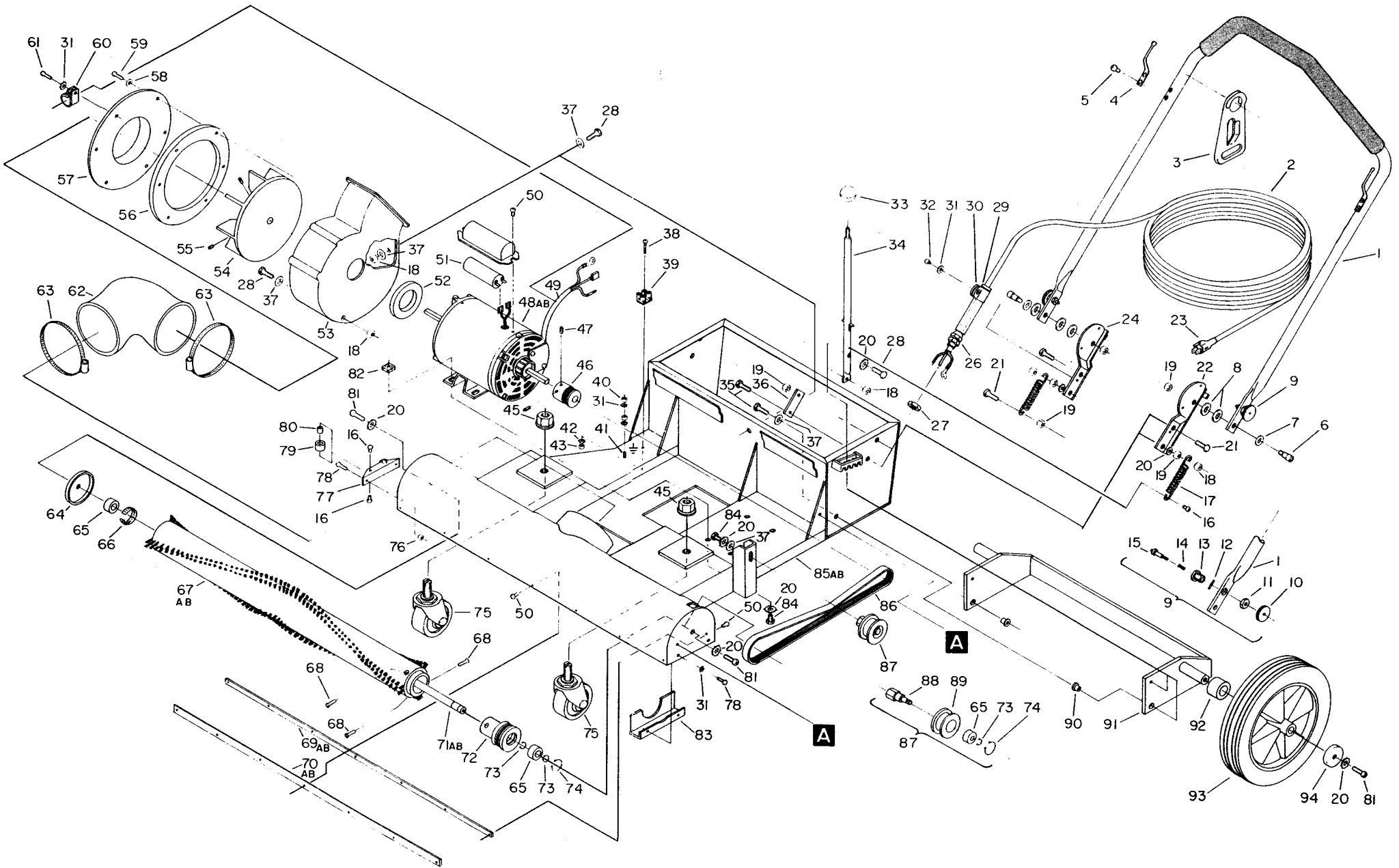

MX22 & MX28 CHASSIS ASSEMBLY PARTS LIST

KEY	PART NO.	DESCRIPTION	KEY	PART NO.	DESCRIPTION	KEY	PART NO.	DESCRIPTION
1	38119	Handle Asm., w/Grip	35	70249	Scr., 1/4-20 x 1.25" HHMS	67A	12004	Brush, MX28
2	23123	Cord Asm., 115V & 230V	36	62161	Plate, Handle Nut	67B	12011	Brush, MX22
3	73169	Strain Relief, Cord Hook	37	87013	Washer, 1/4 ID x 5/8" OD	68	70068	Scr., 10-32 x 3/4" FHMS
4	41014	Hook, Handle	38	70245	Scr., 4-40 x 3/4" PHMS	69A	73230	Shoe, Rear Brush Housing MX28
5	70197	Scr., 1/4-20 x 1/2" PHST -F-	39	14122	Block, 4 Point Terminal	69B	73288	Shoe, Rear Brush Housing MX22
6	70078	Scr., 5/16" OD x 3/8" L	40	57014	Nut, 10-32 Hex	70A	73229	Shoe, Front Brush Housing MX28
7	87003	Washer, 3/8" ID x 7/8" OD	41	70066	Scr., 10-32 x 3/4 PHMS	70B	73287	Shoe, Front Brush Housing MX22
8	87030	Washer, 3/8" ID x 3/4" OD Nylon	42	87082	Washer, #4 Star	71A	03037	Axle, Brush MX28
9	51056	Lock Asm., Handle	43	57100	Nut, 4-40 Hex	71B	03046	Axle, Brush MX22
10	48027	Knob, Handle Lock	44	87012	Washer, 7/16 Star	72	64037	Pulley, Brush
11	57097	Nut, 5/8-18 UNF Jam	45	57099	Nut, 7/16-14 Flange Lock	73	67094	Ring, 1/2" External Snap
12	66089	Pin, 3/32" x 1/2" Center Groove	46	64038	Pulley, Motor	74	67093	Ring, 1.12" Internal Snap
13	14332	Bushing, Handle Lock	47	70074	Scr., 10-32 x 1/4" KCP Set	75	18022	Caster, 3" Swivel
14	73232	Spring, 1/2" L Compression	48A	53143	Motor, 115V Brush Drive	76	57030	Nut, 10-32 Lock
15	66088	Pin, Handle Lock	48B	53144	Motor, 230V Brush Drive	77	14324	Brkt., Guide Wheel
16	70234	Scr., 10-32 x 3/8" PHST	49	88278	Wire Lead Asm., Motor	78	70162	Scr., 10-32 x 3/8" PHMS
17	73224	Spring, 1.75 L Extension	50	70233	Scr., #10 x 3/8" PH Hi-Lo	79	89047	Wheel, Guide
18	57047	Nut, 1/4-20 Lock	51	27271	Capacitor, 233-280 MFD	80	73228	Spacer, Guide Wheel
19	57065	Nut, 1/4-20 Jam	52	35073	Gasket, Motor/Impeller	81	70085	Scr., 1/4-20 x 1/2" PHMS
20	87025	Washer, 1/4 Star	53	41113	Housing, Impeller	82	57080	Nut, 1/4-20 Captive
21	70015	Scr., 1/4-20 x 3/4" HHMS	54	42047	Impeller	83	36061	Guard, Belt/Pulley
22	14327	Brkt., Left Handle	55	70072	Scr., 5/16-18 x 3/8" KCP Set	84	70011	Scr., 1/4-20 x 5/8" HHMS
23	26006	Cord End, 115V, 15A 3 Wire	56	35078	Gasket, Impeller Housing Cover	85A	34136	Frame, MX22
24	14326	Brkt., Right Handle	57	27270	Cover, Impeller Housing	85B	34155	Frame, MX28
26	73195	Strain Relief, 1/2" NPT	58	87018	Washer, #10 Flat	86	11018	Belt
27	57040	Nut, 1/2" NPT Conduit	59	70066	Scr., 10-32 x 3/4 PHMS	87	64039	Pulley Asm., Idler
28	70015	Scr., 1/4-20 x 3/4" HHMS	60	20054	Clamp, 3/8" Dia. Nylon	88	03038	Axle, Idler Pulley
29	27050	Cable Tie, 3.5"	61	70160	Scr., 10-32 x 5/8" PHMS	89	64040	Pulley, Idler
30	20062	Clamp, 3/8 OD Nylon	62	29127	Duct, Intake	90	73237	Spacer, Axle Brkt.
31	87016	Washer, #10 Star	63	20017	Clamp, 4.5"-5.0" Dia.	91	14328	Brkt.: Axle Pivot
32	70228	Scr., 10-32 x 1/4" PHMS	64	36063	Guard, Thread	92	73227	Spacer, Wheel
33	48026	Knob, Brush Height Adj.	65	09019	Bearing, Brush	93	89044	Wheel, 10" x 1.75"W
34	51077	Lever Asm., MX Brush Adj.	66	67098	Ring; Tolerance	94	27266	Cap, Wheel Hub

MX22 & MX28 UPPER ASSEMBLY

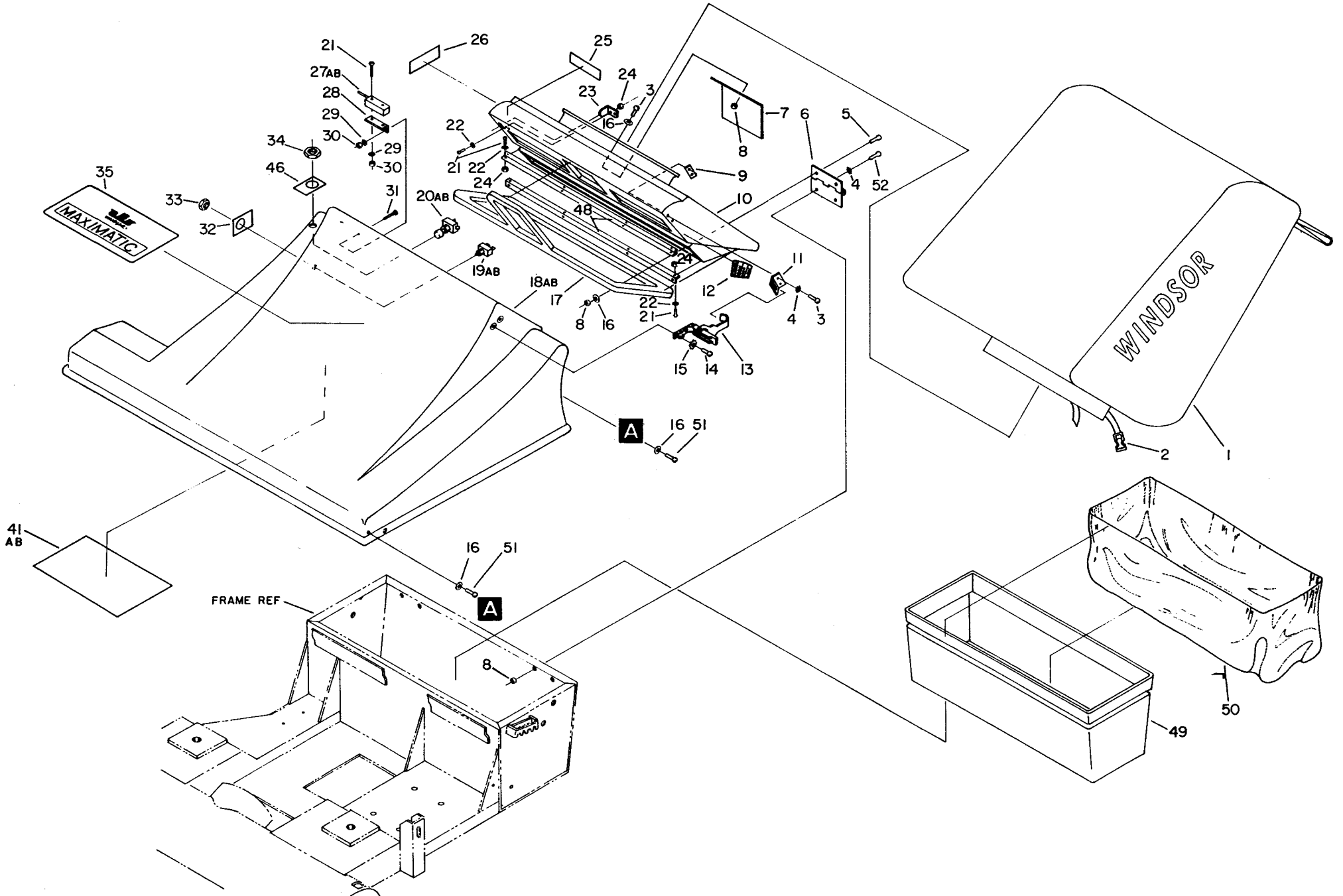

NOTES:

WINDSOR LIMITED WARRANTY

WINDSOR warrants to the original purchaser/user that this product is free from defects in workmanship and materials under normal use and service for a period of one year from date of purchase. WINDSOR will at its option, repair or replace without charge, except for transportation costs, parts that fail under normal use and service when operated and maintained in accordance with the applicable operation and instruction manuals. This warranty does not apply to normal wear, or to items whose life is dependent on their use and care, such as cords, switches, hoses, rubber parts, electric motor parts, etc.

This limited warranty is in lieu of all other warranties, expressed or implied, and releases WINDSOR from all other obligations and liabilities. It is applicable only in the U.S.A. and Canada, and is extended only to the original user/purchaser of this product. WINDSOR is not responsible for costs for repairs performed by persons other than those specifically authorized by WINDSOR. This warranty does not apply to damage from transportation, alterations by unauthorized persons, misuse or abuse of the equipment, use of noncompatible chemicals, or damage to property, or loss of income due to malfunctioning of the product.

If a difficulty develops with this machine, you should contact the dealer from whom it was purchased.





WINDSOR INDUSTRIES, INC., 1351 W. Stanford Ave., Englewood, CO 80110 USA • 303/762-1800 • FAX 303/762-0817