

KENT

MODEL KC 120E

COMMERCIAL UPRIGHT

OPERATING, MAINTENANCE INSTRUCTIONS & ILLUSTRATED PARTS LIST

OCTOBER 1983

Write the model and serial number of your unit in the space provided. Refer to the rating plate on unit.

Model #

Serial #

Retain this owner's guide for future reference.

THE KENT COMPANY

P.O. Box 1665

2310 Industrial Parkway

Elkhart, IN 46514

TEL: (219)293-8661, (800)334-1083

FAX: (219)295-8610

TELEX: 25-8331 KENT CO EKR

IMPORTANT SAFEGUARDS

Accidents due to misuse can only be prevented by those using the machine. To guard against injury, basic safety precautions should be observed, including the following:

Read and follow all safety instructions. **WARNING—ELECTRIC SHOCK COULD OCCUR IF USED OUTDOORS OR ON WET SURFACES**

This vacuum cleaner is designed to be safe when used to perform cleaning functions as specified in the Owner's Guide. Should damage occur to electrical or mechanical parts, cleaner and/or accessory should be repaired by manufacturer or competent service station before using in order to avoid further damage to machine or physical injury to user.

A damaged power cord could cause electrical shock and/or fire. To minimize this possibility observe the following precautions:

Do not run cleaner over power cord.

Avoid closing doors on power cord, pulling it around sharp edges, or placing sharp-edged objects upon it.

On machines without cord reels, wind cord no tighter than is necessary to retain it. Refer to Owner's Guide.

When disconnecting power cord from electrical outlet, grasp the plug. Pulling it out by the cord itself can damage cord insulation and internal connections to plug. Also, avoid damage to insulation by keeping cord away from oil and heat.

Your vacuum cleaner creates suction and contains a revolving brush. To avoid bodily injury from suction or moving parts, vacuum cleaner brush, hose, wands, and attachments should not be placed against, or in close proximity to, loose clothing, jewelry, hair, or body surfaces while cleaner is connected to electrical outlet. Cleaner should not be used to vacuum clothing while it is being worn.

Whenever possible plug your cleaner into a standard wall outlet. Use of extension cord or light socket with inadequate current-carrying capacity could result in electric shock or fire hazard.

Disconnect cleaner from electrical outlet before servicing, such as changing bags or belts. You could receive bodily injury from moving parts of machine should switch accidentally be turned on.

When using your cleaner to vacuum another electrical appliance, such as removing lint from a clothes dryer, be sure to disconnect appliance being vacuumed from the electrical outlet in order to minimize chances of electrical shock.

Do not use your vacuum cleaner in areas where flammable and/or explosive vapor or dust is present to avoid possibility of fire or explosion. Some cleaning fluids can produce such vapors. Areas on which cleaning fluids have been used should be completely dry and thoroughly aired before being vacuumed.

Attachments such as demolishers and paint sprayers can cause toxic, flammable, explosive, or suffocating vapors in indoor areas. Use only attachments recommended by manufacturer of your vacuum cleaner.

To avoid fire hazard, do not pick up matches, fireplace ashes, or smoking material with cleaner.

Keep your work area well lighted to avoid picking up harmful materials (such as liquids, sharp objects, or burning substances) and/or tripping accidents.

Use care when operating the cleaner on irregular surfaces such as stairs. A falling cleaner could cause bodily injury and/or mechanical damage. Proper storage of machine in an out-of-the-way area immediately after use will also prevent accidents caused by tripping over cleaner.

Store your vacuum cleaner indoors in a cool, dry area not exposed to the weather to avoid electrical shock and/or cleaner damage.

Exercise strict supervision to prevent injury when using vacuum cleaner near children or when child is allowed to operate vacuum cleaner. Do not allow children to play with vacuum cleaner and never leave cleaner plugged in and unattended.

SAVE THESE INSTRUCTIONS

GENERAL INFORMATION

BEFORE YOU PLUG IN YOUR CLEANER, check the voltage rating plate located underneath the cleaner to check if it agrees within 10% of the voltage available.

DO NOT OIL. The motor in your new cleaner is permanently lubricated and sealed. Do not oil the motor at any time.

For longer service life and safe use of your vacuum cleaner, we recommend the following guidelines

Your cleaner is designed to pick up dirt and dust particles. Avoid picking up hard or sharp objects with your cleaner to avoid bag breakage, hose clogging, or possible motor damage.

HOW TO USE YOUR VACUUM CLEANER

Three-Position Handle Adjustment

With the tip of your toe, release the handle lock located at the rear left side of the cleaner and move the handle to the desired position (1) Upright when not in use. (2) Normal for sweeping. (3) Low when cleaning under low furniture. (Fig. 1)

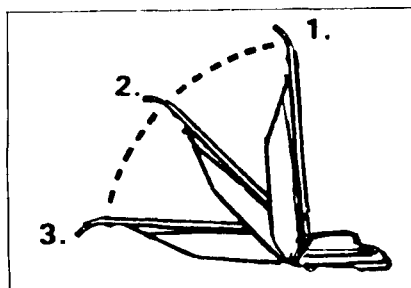

Fig. 1



Fig. 2



Fig. 3

Edge Cleaner

Edge cleaner feature provides for improved cleaning of carpets near walls and stationary furniture. Slots on the sides of the nozzle increase air flow to the edges of the cleaner and add to the cleaning efficiency of the cleaner. To operate, simply run cleaner along edge board. Edge Cleaner operates instantly and automatically.

Power Switches

STEP ON PUSH SWITCHES are mounted on the motor hood. A push with the foot turns the motor ON, push again to turn the motor OFF. (Fig 2)

Cord Storage

Your cleaner has two convenient cord storage hooks attached to the handle. Just wind cord around hooks and fasten with cord holder molded on plug.

TO COMPENSATE FOR WEAR

NOTE — Disconnect power cord from electrical outlet before removing brush roll.

Two types of brush rolls are used on upright cleaners, aluminum and steel. Follow directions given below for your type.

Aluminum Type

The aluminum brush roll is equipped with removable brushes that can be replaced after they become worn. Remove brush roll. (See "The Brush Roll Belt.") Remove end cap by removing end cap nut. Press down on inner end of brush strip with screwdriver and push outward. Push new brush strip in, clip first, so that clip slides into brush roll completely. Replace end cap and repeat process with other brush strip. (Fig. 3)

Steel Type

Repeat process described under "Aluminum Type".

RUG ADJUSTMENT

Fig. 4

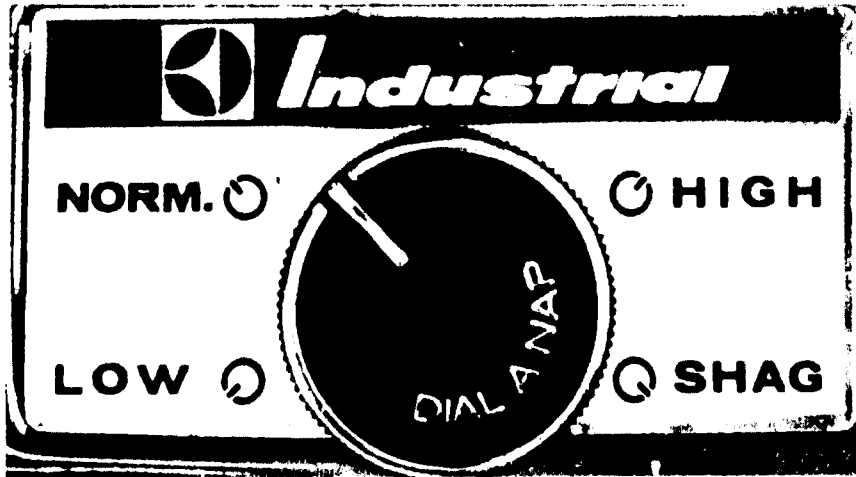

The modern varieties of carpet types, materials and densities require a wide range of vacuum cleaner nozzle height settings to assure best carpet cleaning and grooming.

Your cleaner has a 4-position knob adjustment. The nameplate bears relative pile depth designations. "LOW", "NORMAL," "HIGH" and "SHAG." The adjustment designations are a general guide only. For most satisfying and efficient carpet cleaning, follow this adjustment procedure. (Fig 4)

Move knob to highest position and turn on motor. Listen to the sound of your cleaner; the main sounds will be the motor itself and the rush of air through it, unless you are on very long shag pile. Turn the knob to the next lower

settings, step by step, until the sound changes to a smooth buzzing or vibrating tone. This is the sound of the beater bars grooming the pile.

You will want to experiment with your new cleaner's settings on all your carpeting in order to quickly decide what adjustment is best for each. The choice will soon become second nature to you.

NOTE: After learning best settings for your carpets, you may choose to slightly raise the front of the cleaner for ease in changing the adjustment.

TOP-FILLING DUST BAG PRINCIPLE

The dirt enters the dust tube and falls into bag from top. (Fig. 5).

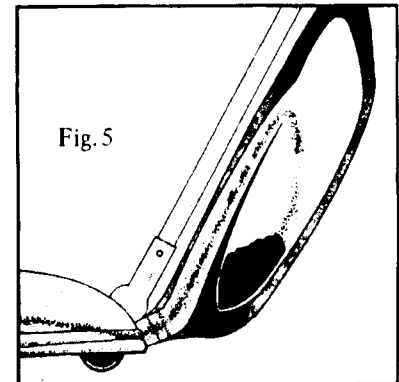

How To Empty Dust Bag

NOTE—Disconnect power cord from electrical outlet before emptying bag.

To Remove: Slide top of bag out of open end of clamp (Fig. 9). It is not necessary to remove clamp from handle. Remove bag from cleaner by pulling back lever arm (A) on bag collar (Fig. 10). Dirt cannot fall out. Spread a newspaper or other disposable material on floor. Hold bag by collar and open opposite end. Shake bag vigorously several times over newspaper (Fig. 11).

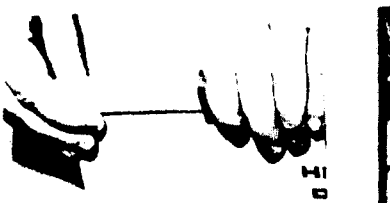

Fig. 9



Fig. 10



Fig. 12

**NOTE
NEVER WASH
OR
DRY-CLEAN BAG**

To replace: Place tab on bottom of bag collar into slot on cleaner base (Fig. 8). Push collar forward so locator pin (B) fits into slot and push lever arm (A) forward to lock bag in place (Fig. 10). Slide top of bag back into clamp (Fig. 9). Note: If bag with zipper is used without a paper bag, remove coil spring over plastic throat.

THE BRUSH ROLL BELT

The brush roll belt on the upright vacuum cleaner drives the brush roll to provide agitation, sweeping action, and combing of the nap.

When To Replace

The belt should be checked regularly to be sure it is in good condition. Check to see if the belt has stretched or cracked, or excessive slipping is occurring. Replace if needed.

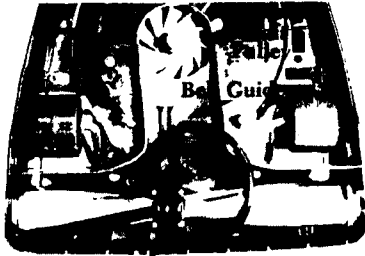

Brush Roll Pulley

Fig. 17

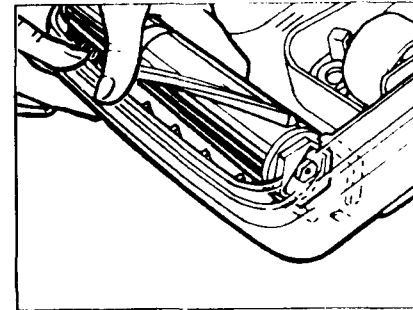

Fig. 18

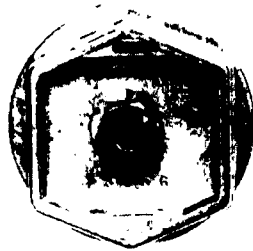
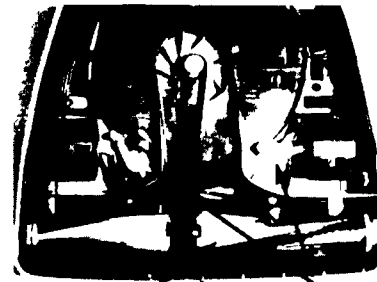

Fig. 19



Brush Roll

Cam Locks

Fig. 20

How To Replace A Worn Belt

NOTE — Disconnect power cord from electrical outlet before replacing belt.

Remove the chrome bottom plate by turning the two cam locks on each side. Remove the worn belt from the motor shaft pulley. (Fig. 17). To remove the brush roll, grasp in center near brush roll pulley and lift upward and slightly forward. (Fig. 18). Place new belt around brush roll. When replacing brush roll be sure brush roll pulley lines up with groove in base of cleaner.

CHECK FOR BRISTLE WEAR — SEE INSTRUCTIONS "To Compensate For Wear."

The brush roll end cap has six sides. Two of these sides are longer. Insert the brush roll into the base so the long sides are nearly vertical and parallel with slots in the base. Push down gently and firmly until the brush roll is seated (Fig. 19). Hook belt around motor pulley shaft making sure the lower side of the belt is in belt guide. (Fig. 20) Replace chrome bottom plate by placing tab of plate into slot of cleaner base. Seat chrome bottom plate flat on cleaner base. Secure with cam locks.

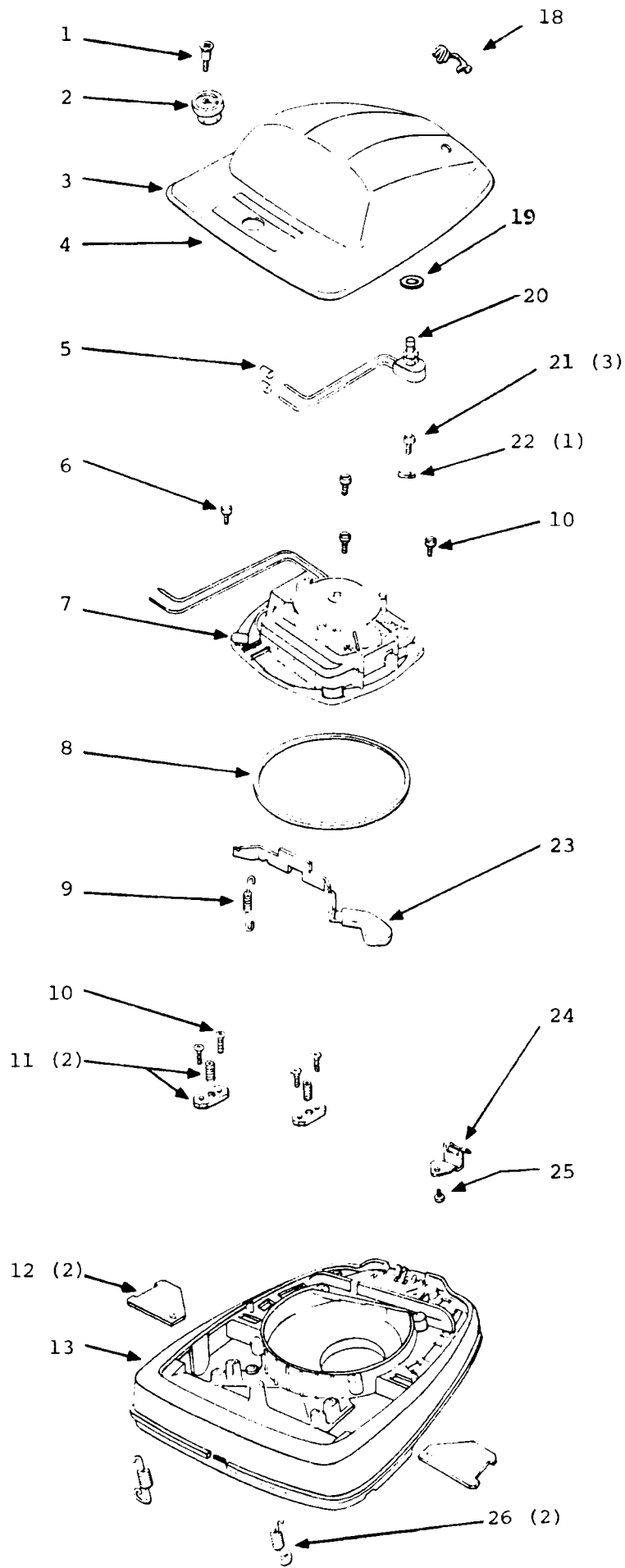

Not Illustrated
 (14, 15, 16, 17)

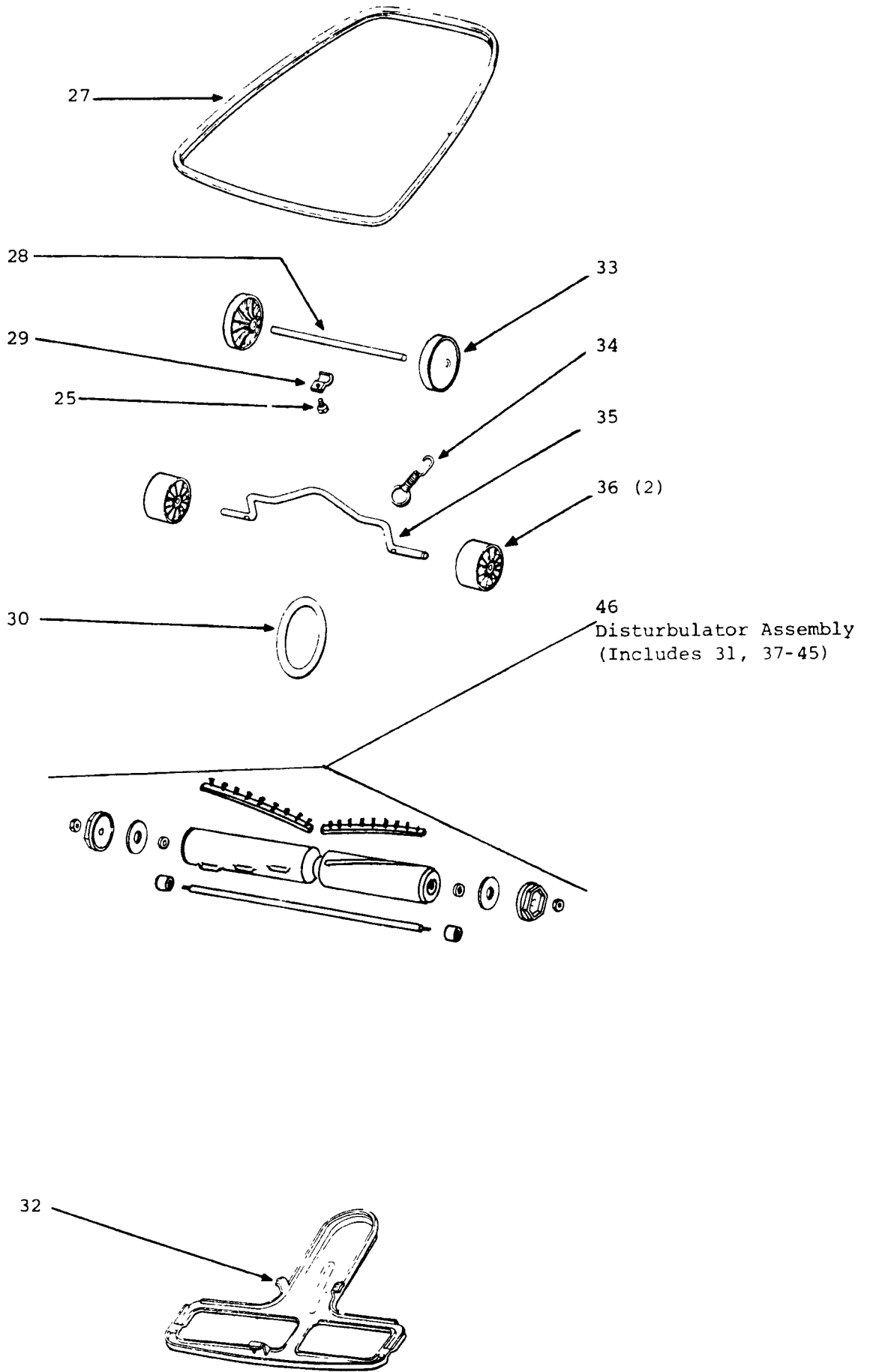

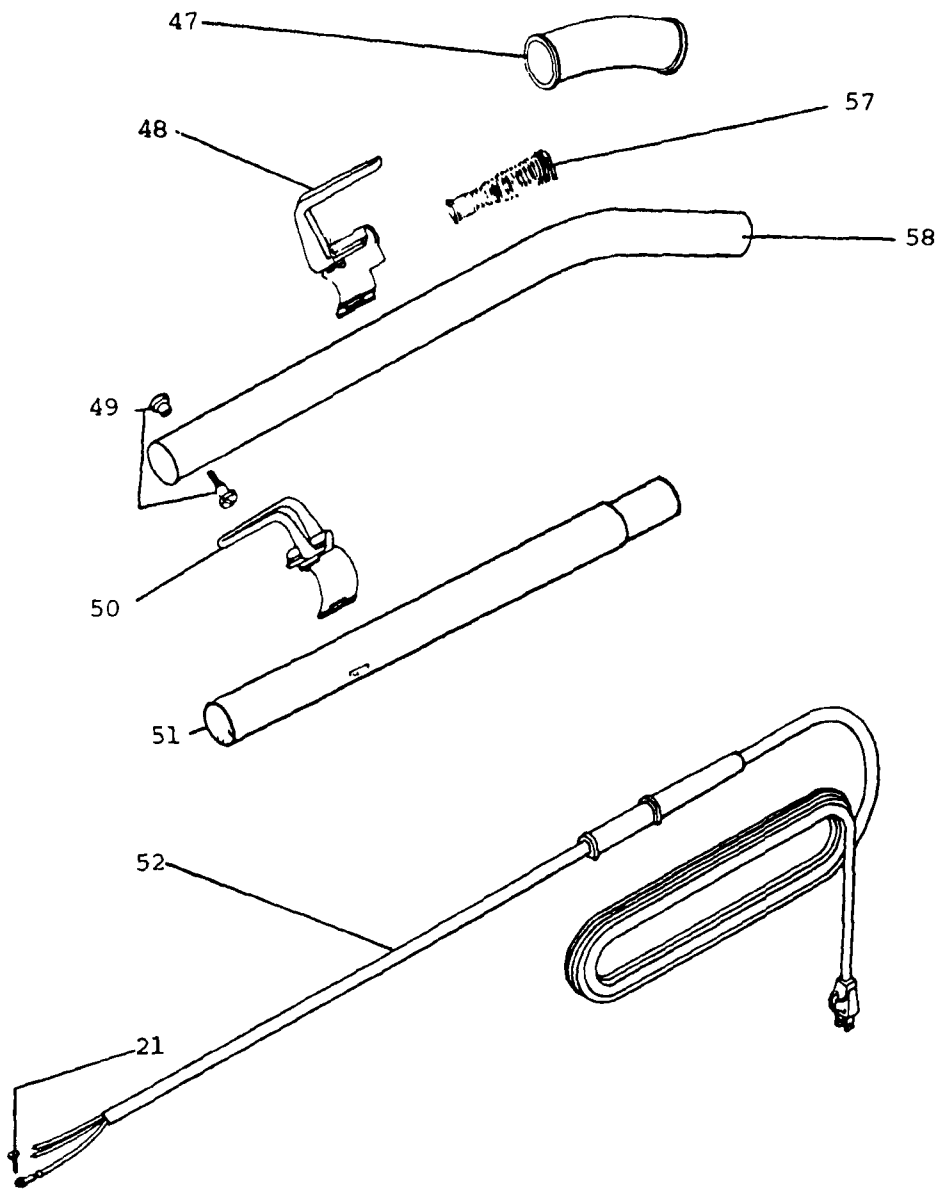

59 Bag Assembly

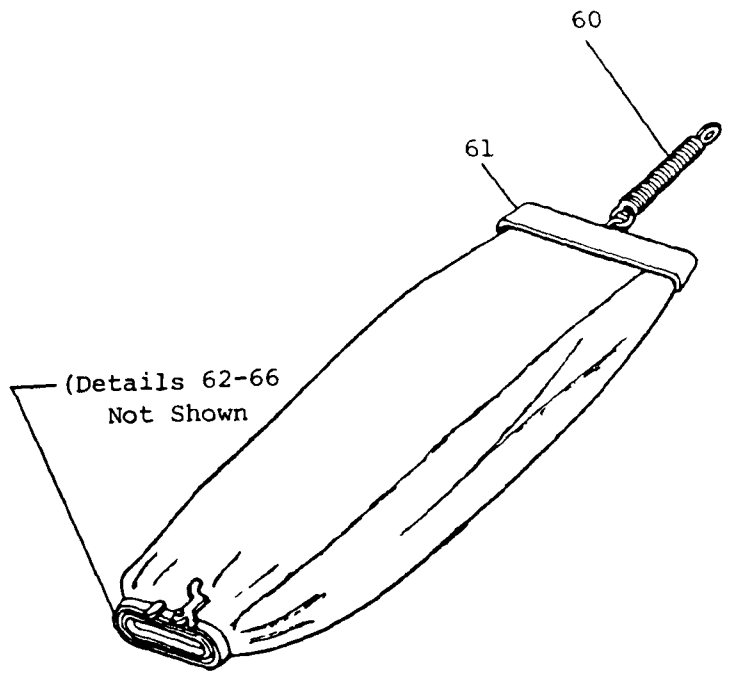
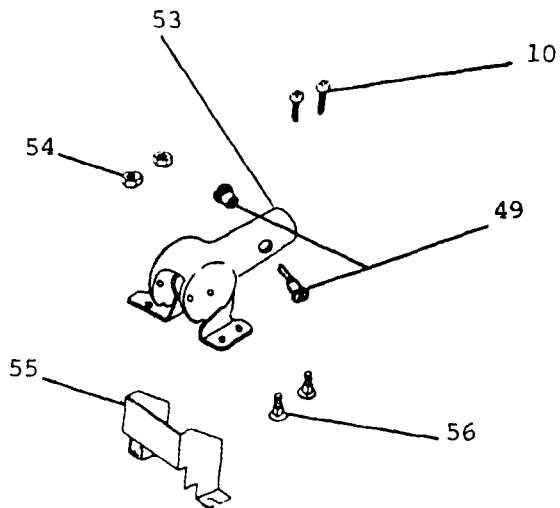

67 Hardware Package (Not Shown)
(Includes 30, 48, 49, 50)

SEQ NO.	PART NO.	DESCRIPTION	QTY
1	E48868	SCR SHLDR TPG F 12-B ,.172S	1
2	E12962-1	KNOB, PLASTIC--UPRT, 6 POS, BLACK	1
3	E12466A-10	HOOD-MOTOR--KENT WHITE	1
4	053591	LABEL, IDENT--KENT, 6 POS, UPRT, 4	1
5	222244	NUT, WIRE--IDEAL 71B	3
6	002423	SCR TPG F PAN HD 10-T X.625L	1
7	E11073-23	ASM, MOTOR--	1
8	E30517	GASKET-MOTOR SEAL	1
9	E45503	SPRING, EXT .257D 1.25L .035WD	1
10	002430	SCR TPG F PAN HD 10-B X.812L	9
11	E48823	ASM, CLAMP & SCREW--	2
12	E36263	COVER-WHEEL	2
13	038425	ASM, BASE--KC120-B	1
18	E48114	BSHG, STRAIN RLF--HEYCO SR6N3-4	1
19	E45943	WSHR LK .508ID.625OD.022T INT	1
20	E36409-13	SWITCH, PUSH--SPST, 10A, 125V	1
21	005313	SCR TPG F PAN HD 8-32X.312L	3
22	E49301	CLAMP, LOOP--.250DIA	1
23	E24834A-1	PEDAL-FOOT--FAWN BEIGE, C2035G	1
24	E37034	SPRING-ADAPTER RETAINER	1
25	002417	SCR TPG F PAN HD 10-TX.500L	2
26	E47853	SPRING, EXT .304D .930L .055WD	2
27	E25648-8	GUARD, FURNITURE	1
28	E47562	RD, STL--.247DIA, 8.19L	1
29	E47586	CLIP	1
30	E30563A	BELT-DISTURBULATOR DRIVE	1
31	E13236-1	TUBE, DISTURBULATOR--KU2037-A	1
32	E25922-1	ASM, PLATE--BOTTOM	1
33	E35858-1	WHEEL--2.50DIA, .250BORE, 1.00HB	2
34	E36407A	SPRING, EXT .275D 1.50L .024WD	1
35	E35947A	AXLE-FRONT (C2035G)	1
36	E35859A-1	WHEEL--2.25DIA, .322BORE, 1.62HB	2
37	E25757-5	ASM, STRIP--BRISTLE, LONG, .375LG	1
38	E25756-5	ASM, STRIP--BRISTLE, SHORT	1
39	E49561	WSHR SLTD .152X.244, .406OD.025	2
40	E49899	WSHR, FELT--1.00ID 1.50OD.047T	2
41	E49175	NUT, HEX LOCK-- 10-32, NYLOC	2
42	E25759A	CAP, DISTURBULATOR--UPRIGHTS	2
43	E37377	ASM, RETAINER & BEARING--	2
44	E49288	BRG, SLV-- .242ID, .440OD, .500W	2
45	E37378	SHAFT, DISTURBULATOR--UPRIGHTS	1
46	E25763-2	ASM, DISTURBULATOR--KU2037-A	1
47	E35293-18	GRIP, HANDLE--BLACK	1
48	E13153-2	RETAINER-CORD *UPPER*	1
49	E55468-1	ASM, SCREW--HANDLE	2
50	E13154-2	RETAINER-CORD *LOWER*	1
51	E12637-8	TUBE-HANDLE LOWER CHROME	1
52	E36577A-11	CORD, POWER--18-3, SJT, BLK, 50'	1
53	E37456-1	ASM, HANDLE SOCKET--UPRIGHT	1
54	003279	NUT, HEX-- 10-24, ZN PLT	2

55	E36439	SHIELD-HANDLE SOCKET	1
56	E48870	SCR CAP TR HD 10-24X.593L	2
57	E36536	SPRING,COMP .625D 2.12L .042WD	1
58	E12636-14	TUBE-HANDLE UPPER CHROME	1
59	E24716C-6	ASM,BAG--FINAL	1
60	E47722	SPRING,EXT .531D 3.89L .054WD	1
61	E30599D-10	CLIP--BAG,CHROME OVER NKL PLT	1
62	E52253-1	BAG,ADAPTER--SERVICE ITEM ONLY	1
63	E37032	CAM-BAG ADAPTER LOCK	1
64	E48282	GASKET	1
65	E48749	RIVET,SHLDR--.123 DIA,.110S	1
66	E48748	WSHR FLT .127ID.375OD.030T STL	2
67	E55628	HARDWARE PKG-COMM UPRGHT SC886	1

THE KENT LIMITED WARRANTY

Your Kent equipment which has been manufactured, tested and inspected in accordance with carefully specified engineering requirements, is warranted to be free from defects in material and workmanship. This warranty is, however, subject to the following qualifications, conditions, and limitations which are set forth to provide you and all users of the Kent equipment with information concerning the duration, extent, availability, and applicability of this Kent limited warranty, the procedure to be taken to obtain its performance, and other information concerning the Kent warranty policy.

The Kent Limited Warranty is extended to the original end user as follows:

KC180, KC300E, PV1000A, KT151 and KD3S 3 year parts replacement and 1 year service labor warranty

Upright carpet vacuums KSR14, KX20SC, KS270, KT151 power head and PV1000A power head 1 year parts replacement and service labor warranty.

KC110A upright 90 days parts replacement and service labor warranty.

Replacement parts guaranteed for 90 days from date of installation against defects in material and workmanship

The 10 year poly component replacement warranty with 1 year service labor extends for a period of ten (10) years from the date of the original purchase of the Kent equipment by the original purchaser. This warranty will not cover damage attributable to the following:

- (1) Improper, unreasonable or negligent use or abuse of the equipment.
- (2) Use of equipment with hot water or high temperature above 130 degrees Fahrenheit (54 degrees centigrade)
- (3) "Warpage", "Creepage", or "Distortion" of part so long as the same does not interfere with normal operation
- (4) Abrasions or punctures of the equipment.

The start date of the warranty coverage shall be the purchase date of the original end user or six months from the date the machine was shipped from the factory, whichever comes first.

PARTS OF KENT EQUIPMENT NOT COVERED BY WARRANTY

Certain parts of Kent equipment require replacement in the ordinary course of use due to normal wear by reason of their characteristics. These are normal wear items such as cords, gaskets, switches, bumpers, carbon brushes, handle grips, bags, hoses, bearings, etc.

EXCEPTIONS AND EXCLUSIONS FROM WARRANTY

This equipment is required to be used on electric current as indicated on the data plate. Otherwise damage, defects, malfunctions or other failures of the equipment arising from use on electric current not as indicated are excepted and excluded from this warranty. Defects, malfunctions, failure or damage of the equipment caused by improper, unreasonable or negligent use or abuse while in the possession of the purchaser are likewise excluded from this warranty. If repair is done on your equipment by anyone other than those designated as authorized to perform such work without first having obtained factory instructions, The Kent Company, at its sole option, may determine that this warranty will not apply and that reimbursement for such repair will not be made because of the failure to comply with such factory specified instructions.

PROCEDURE TO BE TAKEN TO OBTAIN PERFORMANCE OF WARRANTY REPAIR

To secure repair of the equipment or any warranted parts under this warranty, the following procedure should be taken. The inoperative equipment or warranted parts, together with satisfactory evidence of the purchase date, must be delivered, with shipping and delivery charges prepaid, to one of the following:

- (1) The dealer from whom purchased;
- (2) Any Kent distributor's service department in the United States;
- (3) Any Kent authorized service station in the United States.

If you are unable to locate any of the foregoing, you may write or otherwise communicate with The Kent Company for instructions before repair service is performed by anyone else. In such event, The Kent Company will provide either the location of a closely available Kent distributor service department or Kent authorized service station or other factory instructions. Upon compliance with the above procedure, all warranted defects will be repaired, at no additional charge or costs to the customer, and the repaired product returned to the customer, with all shipping and delivery charges prepaid. In following the procedures above set forth, PLEASE MAKE CERTAIN to state the Kent model, type and serial number as shown on the data plate of the equipment.

REPLACEMENT

In the event of a defect, malfunction or failure of your Kent equipment or any warranted part to conform with this warranty, The Kent Company may, at its sole option and own expense, replace the equipment or any warranted part with another new identical or reasonably equivalent model or part in lieu of repairing the defect.

NO REFUND OF PURCHASE PRICE

The Kent Company will not, as a matter of its warranty policy, refund the customer's purchase price.

WARRANTY REGISTRATION CARD FOR YOUR KENT EQUIPMENT AND REQUEST FOR INFORMATION

Your Kent Company distributor from whom you purchased your equipment is responsible for the registration of your warranty with the factory. We ask that you cooperate with your distributor in supplying the necessary information on the warranty card so that we may better serve you. Any information or questions you may have concerning your Kent equipment or this warranty may likewise be secured from the factory. This warranty gives you specific legal rights, and you may also have other rights which vary from state to state.

THE KENT COMPANY

P.O. BOX 1665 ELKHART, INDIANA 46515