

KENT



**Compact Portable HEPA
Filtered Dry Vacuum
(ENVIRONMENTAL)
MODEL: PV-1000H**

**OPERATING,
MAINTENANCE
INSTRUCTIONS
& ILLUSTRATED
PARTS LIST**

**THE KENT COMPANY
2310 INDUSTRIAL PARKWAY
P.O. BOX 1665
ELKHART, IN 46515
TELEX: 258331 KENT CO EKR
FAX: 219-295-8610
WATS: 800-334-1083 (OUTSIDE INDIANA)
219-293-8661**

APRIL 1988

WRITE THE MODEL AND SERIAL NUMBER OF YOUR VACUUM IN THE SPACE PROVIDED. REFER TO THE DATA PLATE ON CLEANER.
MODEL # SERIAL#
RETAIN THIS OWNER'S GUIDE FOR FUTURE REFERENCE

IMPORTANT

RULES FOR SAFE OPERATION

Accidents due to misuse can only be prevented by those using this vacuum. To guard against injury, basic safety precautions should be observed. Read and follow all safety instructions, including the following:



CAUTION:

- Warning - To avoid electrical shock, use indoors only.
- This vacuum cleaner is designed for dry pick-up as specified in this manual. Should damage occur to electrical or mechanical parts, cleaner and/or accessory should be repaired by manufacturer or competent service station before using in order to avoid further damage to machine or physical injury to user.
- Connect only to a grounded (3-wire) electrical outlet. (See "Grounding Instruction.")
- A damaged power cord could cause electrical shock and/or fire. To minimize this possibility observe the following precautions:
 - Do not run cleaner over power cord.
 - Avoid closing doors on power cord, pulling it around sharp edges or placing sharp-edged objects upon it.
 - On machines without cord reels, wind cord no tighter than is necessary to retain it.
- When disconnecting power cord from electrical outlet, grasp the plug. Pulling it out by the cord itself can damage cord insulation and internal connections to plug. Also, avoid damage to insulation by keeping cord away from oil and heat.
- Your vacuum cleaner creates suction. To avoid bodily injury from suction, vacuum cleaner brush, hose, wands, and attachments should not be placed against, or in close proximity to loose clothing, jewelry, hair, or body surfaces while cleaner is con-

nected to electrical outlet. Cleaner should not be used to vacuum clothing while it is being worn.

- Whenever possible, plug your cleaner into a standard wall outlet. Use of extension cord or light socket with inadequate current-carrying capacity could result in electric shock or fire hazard.
- When using your cleaner to vacuum another electrical appliance, such as removing lint from a clothes dryer, be sure to disconnect appliance being vacuumed from the electrical outlet in order to minimize chances of electrical shock.
- To avoid electrical shock hazard, always plug your cleaner into a 3-prong grounding-type receptacle if your cleaner is provided with grounded electrical system (3-prong grounding-type plug).
- Disconnect cleaner from electrical outlet before servicing, such as changing bags or belts. You could receive bodily injury from moving parts of machine should switch accidentally be turned on.
- Guide the power cord firmly when retracting it on vacuum cleaners with cord reels to prevent the plug from becoming a flying object and causing bodily injury.
- Do not use your vacuum cleaner in areas where flammable and/or explosive vapor or dust is present to avoid possibility of fire or explosion. Some cleaning fluids can produce such vapors. Areas on which cleaning fluids have been used should be completely dry and thoroughly aired before being vacuumed.
- Attachments such as demathers and paint sprayers can cause toxic, flammable, explosive, or suffocating vapors in indoor areas. Use only attachments recommended by manufacturer of your vacuum cleaner.
- To avoid fire hazard, do not pick up matches, fireplace ashes, or smoking material with cleaner.
- Keep your work area well lighted to avoid picking up harmful materials (such as flammable liquids, sharp objects, or burning substances) and/or tripping accidents.
- Use care when operating the cleaner on irregular surfaces such as stairs. A falling cleaner could cause bodily injury and/or mechanical damage. Proper storage of machine in an out-of-the-way area im-

mediately after use will also prevent accidents caused by tripping over cleaner.

- Store your vacuum cleaner indoors in a cool, dry area not exposed to the weather to avoid electrical shock and/or cleaner damage.
- Exercise strict supervision to prevent injury when using vacuum cleaner near children or when child is allowed to operate vacuum cleaner. Do not allow children to play with vacuum cleaner and never leave cleaner plugged in and unattended.
- Your cleaner is designed to pick up dirt and dust particles; it is **not** designed for water pick up. Avoid picking up hard or sharp objects with your cleaner to avoid bag breakage, hose clogging, or possible motor damage.

CUSTOMER RESPONSIBILITIES

Always use care when operating the machine. Keep clear of moving parts. Do not work on machine with power applied and observe the rules for safe operation. Keep the machine clean. Follow a regular maintenance and check schedule to provide efficient and safe operation. A well cared for machine will last longer and operate efficiently. Always be careful for yourself and for others.

GENERAL INFORMATION

Before you plug in your cleaner, check the voltage data plate located on the cleaner near the power cord to check if it agrees within 10% of the voltage available (see Data Plate figure). Connect only to a grounded (3-wire) electrical outlet.

Do not oil. The motor in your vacuum is permanently lubricated and sealed. Do not oil the motor at any time.

The filter bag may have become dislodged in shipping. Check the bag to insure proper seating before attempting to use the cleaner. Do not operate the cleaner without the filter bag as damage may result to the motor.

SERVICE INFORMATION

To obtain consistent performance over the life of your floor machine, read through these in-

structions and keep them handy for future reference. If you require service, contact the dealer from whom the machine was purchased, or the authorized Kent service station. Always refer to your Kent limited warranty for complete service information.

THE KENT CO.		
ELKHART, INDIANA USA		
SERIAL No	MODEL	
VOLTS	PHASE	Hz
MOTOR 1	A.M.P.	H.P.
MOTOR 2	A.M.P.	H.P.

The model, type, and serial number are indicated on the rating plate. For prompt and complete service information, always refer to these numbers when inquiring about service.

GROUNDING INSTRUCTIONS

This machine should be grounded while in use to protect the operator from electric shock. The appliance is equipped with suitable three-conductor cord and 3-prong grounding-type receptacle. The green (or green and yellow) conductor in the cord is the grounding wire. Never connect the green (or green and yellow) wire to a live terminal. If your unit is for use on less than 150 volts, it has a plug that looks like Figure 1. If it is for use on 150 to 250 volts, it has a plug that looks like Figure 3. An adapter, Figure 2, is available for connecting Figure 1 plugs to 2-prong receptacles. The green (or green and yellow) grounding wire extending from the adapter must be connected to a permanent ground such as to properly grounded outlet box. No adapter is available for Figure 3 plugs.

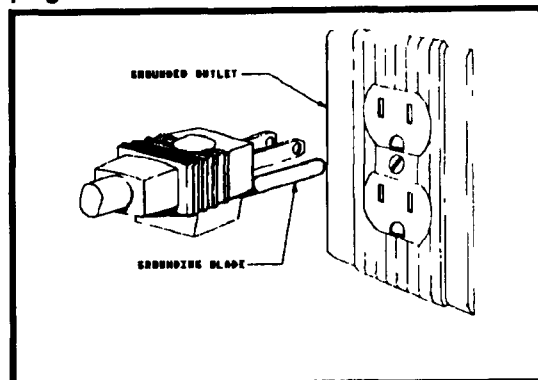

FIG. 1

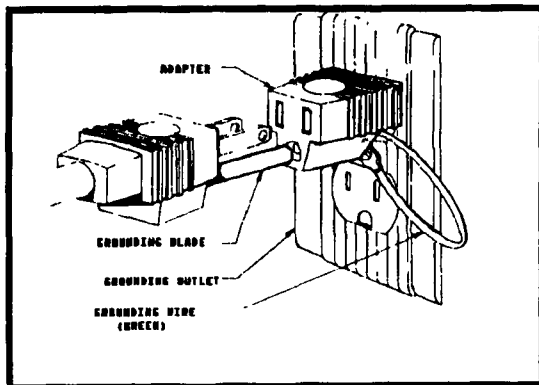

FIG. 2

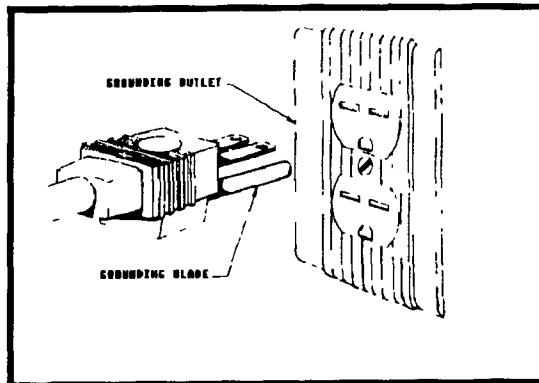

FIG. 3

Use only 3-wire extension cords which have 3-prong grounding-type plugs and 3-prong receptacles that accept the appliance's plug. Replace or repair damaged cords.

THE KENT PELICAN HEPA FILTER EQUIPPED

Your Kent Pelican HEPA filter equipped vacuum cleaner has been carefully engineered and manufactured to give outstanding performance in all cleaning operations.

Careful maintenance of the unit will insure that high standards of performance will be maintained thru its lifetime of operation.

HOW TO USE AND CARE FOR YOUR KENT PELICAN HEPA FILTER EQUIPPED VACUUM

Always operate your Kent Pelican HEPA filter equipped vacuum on the proper voltage as outlined on the data plate.

Before turning your vacuum on, be sure paper bag, Microstat filter, and kidney-shaped filter are in place.

After using for dry application, remove the 51729 kidney-shaped filter and clean thoroughly. This must be cleaned daily to insure top performance. Remove paper bag, and clean base before reusing vacuum, replacing paper bag when one-third full of materials. For added convenience, keep a supply of 16420 disposable filter bags on hand. They may be obtained from your local Kent distributor.

If air movement is interrupted in your vacuum, check the Microstat and the 51729 filter to make sure it is clean. To see if hose has become plugged, remove hose from machine and test suction at machine intake. The vacuum motor is protected by a thermal cut-out switch so that extended use of the motor with interrupted air movement will automatically shut it off. When this situation occurs, the thermal switch must cool down for approximately twelve minutes before it will automatically reset. Remove all blockage in system before using vacuum again.

Store machine in a clean dry place after removing all dirt from the tank and thoroughly cleaning the tools, hose and the outside of the unit.

The carbon motor armature brushes should be inspected after the first 400 hours of operation and frequently thereafter. They should be replaced when worn to 3/8 inch length. Permitting the brushes to be worn to less than 3/8 inch in length invariably will cause damage to the armature thus nullifying the guarantee. Always replace both brushes at the same time.

No other maintenance of the motor is required and none should be attempted during the first year after purchase.

Many tools are available for your Kent Pelican HEPA filter equipped vacuum. Contact your Kent authorized distributor for additional tools

CHANGING THE MICROSTAT FILTER

The Microstat filter should be changed when it is noticeably dirty or machine performance begins to decline.

The filter is changed as follows:

Disconnect the power cord from the wall before unfastening the clamp latches and remove the upper shroud.

Remove the wire filter retainer (See Figure 4).



FIG. 4

Remove the Microstat filter and properly dispose of it (See Figure 5).



FIG. 5

Place the new filter on the kidney-shaped foam filter, quilted side towards the foam and fold the Microstat over the sides of the foam filter.

Reinstall the filters and retain with wire retainer.

Replace the top shroud on the body and refasten the clamps.

Reconnect power cord and test unit for proper operation.

CHANGING THE HEPA FILTER

The HEPA filter assembly should be changed when machine performance begins to decline.

The filter is changed as follows:

Disconnect the power cord from the wall before removing the eight (3) screws holding the screen cover to the top shroud. Remove the cover and gasket (See Figure 6).



FIG. 6

Remove the HEPA filter assembly by gently pulling up on the wire handle (See Figure 7). Properly dispose of the entire filter assembly.



FIG. 7

Install the new assembly by inserting it into the shroud, handle up, making sure that the filter seats positively on the filter mounting brackets.

Inspect the gasket for any damage and replace as required.

Place the screen cover and gasket on the shroud and fasten securely with the eight (3) screws.

Reconnect the power cord and test unit for proper operation.

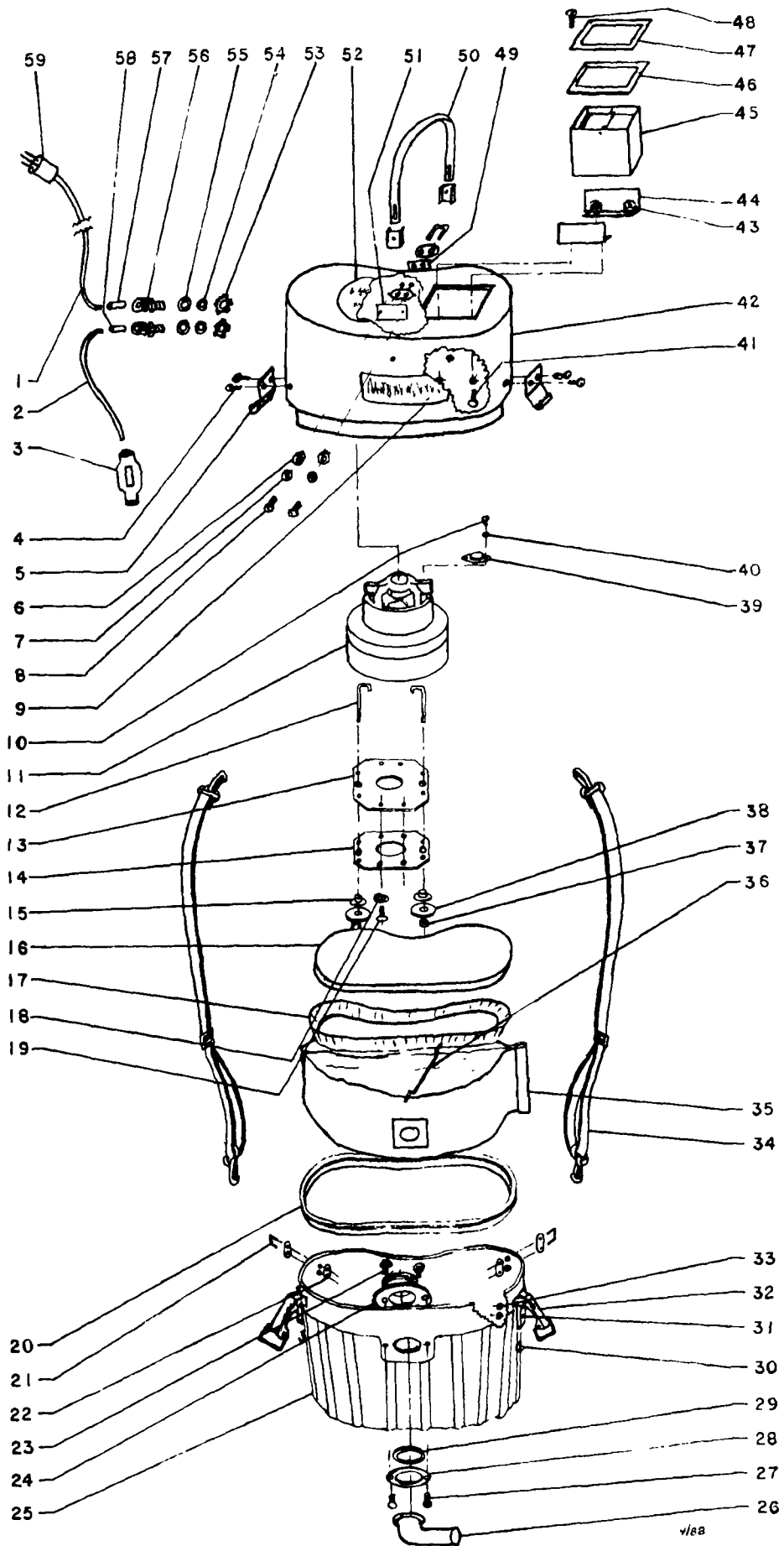

v/ea

S-LQ NO.	PART NO.	DESCRIPTION	Y.
1	025769	CORD,POWER--18-3 SJT,BLK,50*HT	1
2	025773	CABLE,ELEC--18-2,SJT,BLK,4FT	1
3	025775	ASM,SWITCH--CORU,125V,10A,CLIP	1
4	002414	SCR TPG F PAN HD 10-T X.500L	4
5	051327	STRIKE,BODY LATCH--PELICAN ZN.	2
6	003411	NUT,HEX-- 10-24,NYLON	2
7	004253	WSHR LK .204ID.4100D.025T EXT	2
8	005554	SCR NYL RD HD 10-24X.625L	2
9	053952	LABEL,IDENT--KENT,HEPA,1.9X8.5	1
10	001345	SCR TPG F PAN HD 10-24X.250L	1
11	E48373	BRUSH,MTR-	2
11	023371	ASM,MOTOR--VAC	1
11	023377	ASM,MOTOR--VAC,230V	1
12	400502	HOOK MOTOR CLAMPING	2
13	053980	GASKET,NEOPRENE--R/S52304,HEPA	1
14	034275	WDMT,PLATE--MTG,MTR,HEPA PELIC	1
15	111384	BUSHING 1 7/32X3/16	2
16	051729	FOAM FILTER *KIDNEY SHAPE*	1
17	661842	MICR. FILT. PACK	1
18	001327	SCR MACH PAN HD 10-24X.750L	8
19	004253	WSHR LK .204ID.4100D.025T EXT	1
20	052303	SEAL--FLEXIBLE TRIM,.25X39.50L	3
21	051322	EYELET--SHOULDER STRAP PELICAN	3
22	051323	PLATE,BACKING--SHLDR STRP EYLT	2
23	E49028	NUT,SPECIAL--HANDLE	1
24	046810	PORT, INTAKE-MACHINED	1
25	053983	BODY,MACHINED--PELICAN,HEPA,BL	1
26	046822	INTAKE	1
27	E49025	SCR--HANDLE	2
28	046820	INTAKE FLANGE	1
29	046819	INTAKE GASKET	1
30	051325	STRIKE,DOLLY LATCH--PELIC.ZINC	2
31	004492	RIVET,POP--.187 DIA, .375 MAX	4
32	051324	LATCH--PELICAN *ZINC PLATED*	2
33	005323	WSHR FLT .203ID.5000D.035T STL	4
34	016417	SHOULDER STRAP	2
35	016420	DISP FILTER BAG PK OF 10	1
36	052305	WIRE,STL--12GA,FILTER RETAINER	1
37	222223	NUT,HEX LOCK-- 10-32,ZINC	2
38	224015	WSHR FLT .187ID1.000D.063T STL	2
39	051459	MOTOR PROTECTOR--*MODIFIED*	1
40	004253	WSHR LK .204ID.4100D.025T EXT	1
41	001298	SCR MACH RD HD 10-24X.750L	4
42	053956	TOP SHROUD,MACHINED--HEPA,BLUE	1
43	003279	NUT,HEX-- 10-24,ZN PLT	4
44	053974	BRACKET,MOUNTING--HEPA FILTER	2
45	034276	ASM,FILTER--HEPA,PELICAN	1
46	053983	GASKET,NEOPRENE--6.26X6.06X.19	1
47	054049	SCREEN,RETAINING--HEPA,FILTER	1
48	001273	SCR MACH RD HD 10-32X.500L	2
49	051747	GASKET,NEOPRENE--DURD 40,.062T	3
50	053987	HANDLE--PELICAN HEPA,VINYL,BLK	1
51	051241	PLATE,INSULATION-ABS PLASTIC	1
52	052748	LABEL,IDENT--HEPA FILTER	1
53	006108	NUT,SPECIAL--.500 PIPE,HEX LOC	2
54	053702	WSHR FLT .70ID1.380D.093T RBR	2
55	004515	WSHR FLT .875ID1.250D.035T SST	2
56	048356	BUSH,STRAIN RLF--.37-.50 ACCOM	1
57	046350	TUBE,VINYL--.375X.500, 2.75L	1
58	053977	TUBE,VINYL--313X.500, 2.75L	1
59	026675	CONN,PLUG--3-WR,15A,125V,HOSPI	1

THE KENT LIMITED WARRANTY

Your Kent equipment, which has been manufactured, tested and inspected in accordance with carefully specified engineering requirements, is warranted to be free from defects in material and workmanship.

This warranty is, however, subject to the following qualifications, conditions, and limitations which are set forth to provide you and all users of the Kent equipment with information concerning the duration, extent, availability, and applicability of this Kent limited warranty, the procedure to be taken to obtain its performance, and other information concerning the Kent warranty policy.

DURATION OF WARRANTY AND TO WHOM EXTENDED This warranty extends for a period of one year from the date of the original purchase of the Kent equipment by the original purchaser.

PARTS OF KENT EQUIPMENT NOT COVERED BY WARRANTY Certain parts of Kent equipment require replacement in the ordinary course of use due to normal wear by reason of their characteristics. These are normal wear items such as cords, gaskets, switches, bumpers, carbon brushes, handle grips, bags, hoses, bearings, etc.

EXCEPTIONS AND EXCLUSIONS FROM WARRANTY This equipment is required to be used on electric current as indicated on the name plate. Otherwise damage, defects, malfunctions or other failures of the equipment arising from use on electric current not as indicated are excepted and excluded from this warranty.

Defects, malfunctions, failure or damage of the equipment caused by improper, unreasonable or negligent use or abuse while in the possession of the purchaser are likewise excluded from this warranty.

If repair is done on your equipment by anyone other than those below designated as authorized to perform such work without first having obtained factory instructions, The Kent company, at its sole option, may determine that this warranty will not apply and that reimbursement for such repair will not be made because of the failure to comply with such factory specified instructions.

Briggs & Stratton Corporation engines are guaranteed by Briggs & Stratton Corporation for a period of one year. Parts and service are available only through Briggs & Stratton Corporation servicing dealers.

Honda engines are guaranteed by American Honda Motor Co., Inc. for a period of one year. Parts and service are available only through Honda servicing dealers.

Motor Appliance Corp. guarantees all Mac battery chargers to be free from defects in material or workmanship for a period of one year from date of manufacture. The nearest Mac authorized service facility should be contacted for service assistance.

FIVE YEAR POLY COMPONENT WARRANTY Your Kent rotational molded polyethylene parts have been manufactured, tested and inspected in accordance with carefully specified engineering requirements and are warranted to be free from defects in material and workmanship.

This warranty extends for a period of five (5) years from the date of the original purchase of the Kent equipment by the original purchaser.

This warranty will not cover damage attributable to the following:

- (1) Improper, unreasonable or negligent use or abuse of the equipment.
- (2) Use of the equipment with hot water or high temperatures above 130 degrees Fahrenheit (54 degrees Centigrade)
- (3) "Warping", "creepage" or "distortion" of part so long as the same does not interfere with normal operation.
- (4) Abrasions or punctures of the equipment

PROCEDURE TO BE TAKEN TO OBTAIN PERFORMANCE OF WARRANTY REPAIR To secure repair of the equipment or any warranted parts under this warranty, the following procedure should be taken.

The inoperative equipment or warranted parts, together with satisfactory evidence of the purchase date, must be delivered, with shipping and delivery charges prepaid, to one of the following:

- (1) The dealer whom purchased;
- (2) Any Kent distributor's service department in the United States;
- (3) Any Kent authorized service station in the United States.

If you are unable to locate any of the foregoing, you may write or otherwise communicate with The Kent company, for instructions before repair service is performed by anyone else. In such event, The Kent company will provide either the location of a closely available Kent distributor service department or Kent authorized service station or other factory instructions.

Upon compliance with the above procedure, all warranted defects will be repaired, at no additional charge or costs to the customer, and the repaired product returned to the customer, with all shipping and delivery charges prepaid.

In following the procedures above set forth, PLEASE MAKE CERTAIN to state the Kent model, type and serial number as shown on the data plate of the equipment.

REPLACEMENT In the event of a defect, malfunction or failure of your Kent equipment or any warranted part to conform with this warranty, The Kent company may, at its sole option and own expense, replace the equipment or any warranted part with another new identical or reasonably equivalent model or part in lieu of repairing the defect.

NO REFUND OF PURCHASE PRICE The Kent company will not, as a matter of its warranty policy, refund the customer's purchase price.

WARRANTY REGISTRATION CARD FOR YOUR KENT EQUIPMENT AND REQUEST FOR INFORMATION Your Kent company distributor from whom you purchased your equipment is responsible for the registration of your warranty with the factory. We ask that you cooperate with your distributor in supplying the necessary information on the warranty card so that we may better serve you.

Any information or questions you may have concerning your Kent equipment or this warranty may likewise be secured from the factory.

This warranty gives you specific legal rights, and you may also have other rights which vary from state to state.